

Property Name	PARK TOWER SHIBAURA BAYWARD URBAN WING	Unit No.	TYPE	Access	Shibaurafutou Station on (7 min) Tamachi Station on JR Yamanote Line (8 min) Mita Station on Mita Line (9 min)
		1701	Apt.		
Address	2-6-11, Shibaura, Minato-Ku, Tokyo				

## Luxury & Stylish Apartment with a View of Tokyo Bay

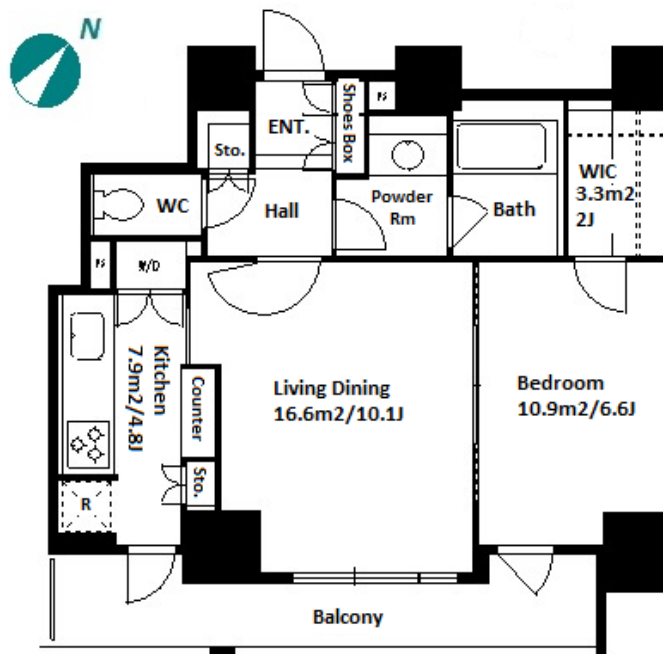
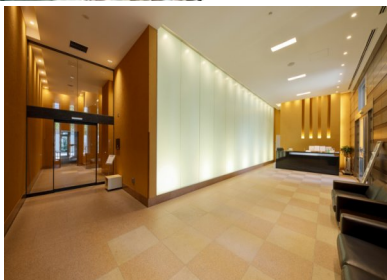

Lease Conditions			
LAYOUT	1 BR		
SIZE	52.43 m²/564.35 ft²		
RENT	JPY 265,000 / month		
Management Fee	JPY8,000/month		
Deposit	2 months	Key Money	1 month
Lease Term	Fixed term lease for 24 months		
Available	End, Mar, 2024		
Renewal Fee	-		
Agent Fee	1 month + tax		
Other Info	Guarantor Company : TBC / Auto lock / Air-Con / Separated Toilet / Balcony / Penalty Fee for Early Cancellation / Musical Instrument Negotiable / CS/CATV / Flooring / Bathroom dryer / WIC		

Building Information			
Completion	Jul, 2005	Earthquake Resistance	New
Structure	RC, 29 story		
Car Parking	TBC		
Bicycle Parking	for 1 space ( Included )		
Music Instrument	Negotiable	Pet	Allowed
Facilities	Within 20 min to Tokyo station by car / Near Large Parks / Front desk / Janitor / Delivery box / Elevator		

Remarks
Pet:additional deposit ( 1 month ) / Pet : a small dog or up to two cats

\*The actual Layout & Size may differ slightly from this floor plans & pictures.



# HOUSEREP TOKYO INC.

ハウスレップトーキョー株式会社

#301, 1-4-15, Hiroo, Shibuya-ku, Tokyo 150-0012, Japan

+81 (0)3 6427 5860 inquiry@houserep-tokyo.com

Transaction Type : Intermediate

Agent Fee : 1 month + tax

Website : www.houserep-tokyo.com

