

Property Name	RESIDIA EBISU II	Unit No.	TYPE	Access	Ebisu Station on Hibiya Line (2 min)
		1403	Apt.		Ebisu Station on JR Yamanote Line (5 min)
Address	1-21-7, Ebisunishi, Shibuya-Ku, Tokyo				Daikanyama Station on Toyoko Line (6 min)

## Stylish Apartment in Ebisu / Daikanyama, Very Close to "Ebisu Station"

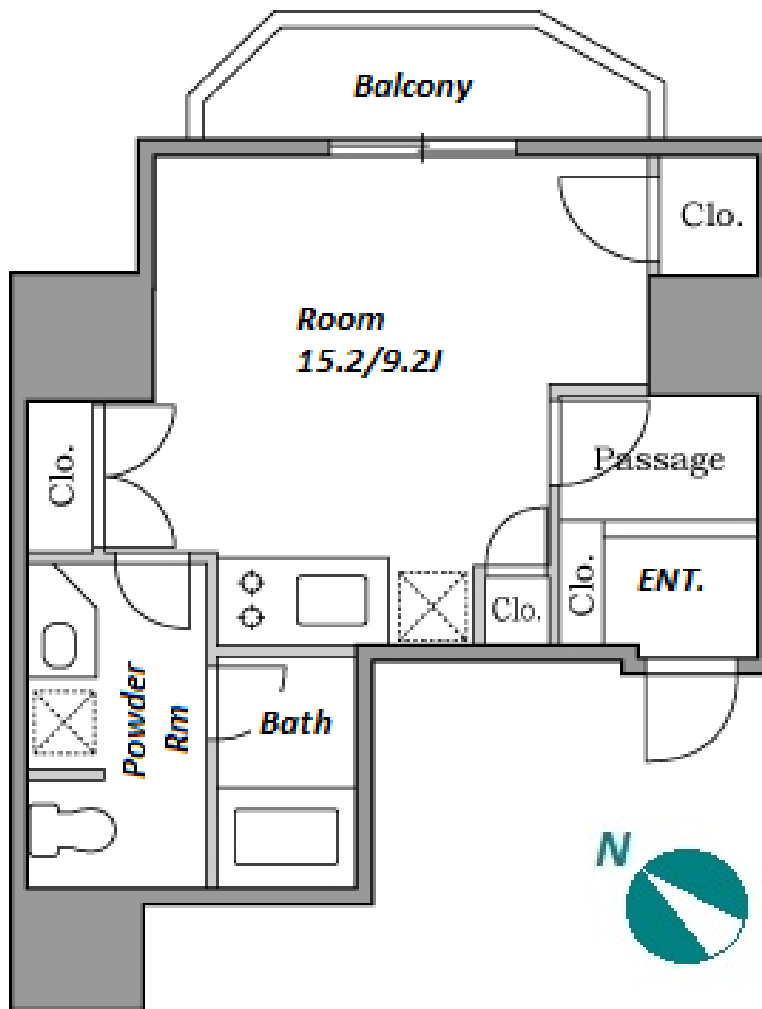

\*The actual Layout & Size may differ slightly from this floor plans & pictures.

Lease Conditions			
LAYOUT	Studio		
SIZE	28.49 m²/306.66 ft²		
RENT	JPY 165,000 / month		
Management Fee	JPY10,000/month		
Deposit	2 months	Key Money	-
Lease Term	Standard lease for 24 months		
Available	Mid, Apr, 2024		
Renewal Fee	1 month		
Agent Fee	1 month + tax		
Other Info	Key Replacement Fee : JPY18,000 Tax not included / No Key Money / Auto lock / Air-Con / Separated Toilet / Balcony / Internet (Extra Charge) / Penalty Fee for Early Cancellation / Nice Views / Flooring / Washer / Dryer / Bathroom dryer		

Building Information			
Completion	Jan, 2006	Earthquake Resistance	New
Structure	RC, 15 story		
Car Parking	TBC		
Bicycle Parking	N/A		
Music Instrument	-	Pet	N/A
Facilities	Motorcycle Parking (TBC) / Delivery box / Elevator		

Remarks
Renters Insurance : Required / Tenant membership fee: 10,000yen+tax/2years / Internet subscription fee: 1,500yen+tax/month / Internet Access : 1,500yen+tax/month



# HOUSEREP TOKYO INC.

ハウスレプトーキョー株式会社

#301, 1-4-15, Hiroo, Shibuya-ku, Tokyo 150-0012, Japan

+81 (0)3 6427 5860

inquiry@housserrep-tokyo.com

Transaction Type : Intermediate

Agent Fee : 1 month + tax

Website : www.housserrep-tokyo.com

