

Property Name	ORIENTAL YOKOYAMACHO	Unit No.	503	TYPE	Apt.	Access	Bakurochou Station on JR Sobu Line (2 min) Bakuroyokoyama Station on Toei Shinjuku Line (2 min) Higashinohonbashi Station on Toei Asakusa Line (2 min)
Address	6-13, Nihombashiyokoyamacho, Chuo-Ku, Tokyo						

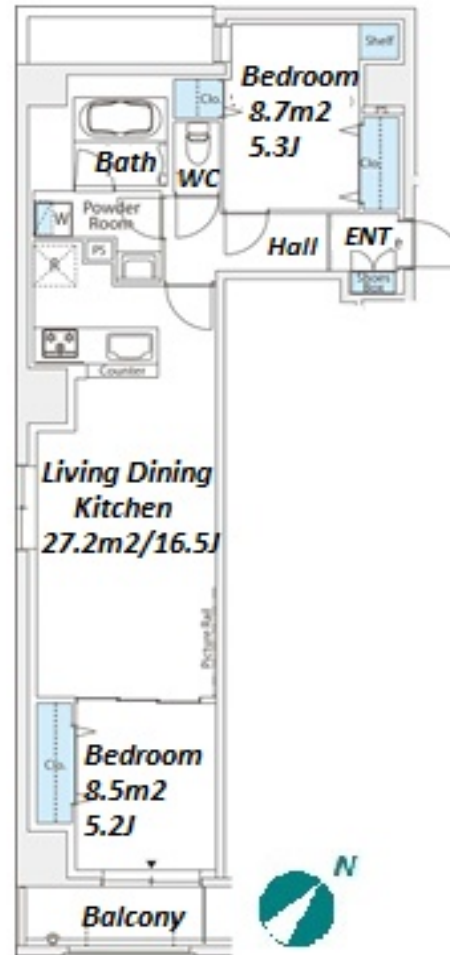

*The actual Layout & Size may differ slightly from this floor plans & pictures.

Lease Conditions			
LAYOUT	2 BR		
SIZE	65.81 m²/708.37 ft²		
RENT	JPY 264,000 / month		
Management Fee	JPY20,000/month		
Deposit	2 months	Key Money	-
Lease Term	Standard lease for 24 months		
Available	Now		
Renewal Fee	1 month		
Agent Fee	1 month + tax		
Other Info	Key Replacement Fee : JPY20,000 Tax not included / Guarantor Company : TBC / No Key Money / Auto lock / Air-Con / Separated Toilet / Balcony / Internet Included / Penalty Fee for Early Cancellation / Flooring / Bathroom dryer		

Building Information			
Completion	Dec, 2023	Earthquake Resistance	New
Structure	RC, 11 story		
Car Parking	N/A		
Bicycle Parking	JPY200 ~ 300 + tax / month		
Music Instrument	-	Pet	-
Facilities	Janitor / Delivery box / Elevator / Close to Station / Newly-built (~1 y/o)		

Remarks
Renters Insurance : Required



HOUSEREP TOKYO INC.

ハウスレップトーキョー株式会社

#301, 1-4-15, Hiroo, Shibuya-ku, Tokyo 150-0012, Japan

+81 (0)3 6427 5860 inquiry@houserep-tokyo.com

Transaction Type : Intermediate

Agent Fee : 1 month + tax

Website : www.houserep-tokyo.com

