

Property Name	RIVER CITY 21 SHINKAWA	Unit No.	TYPE	Access	Hacchoubori Station on Hibiya Line (7 min) Tsukishima Station on Yurakucho Line (13 min) Tsukishima Station on Yurakucho Line (13 min)
		811	Apt.		
Address	2-27-4, Shinkawa, Chuo-Ku, Tokyo				

High-rise Apt. in Shinkawa, along Sumida River

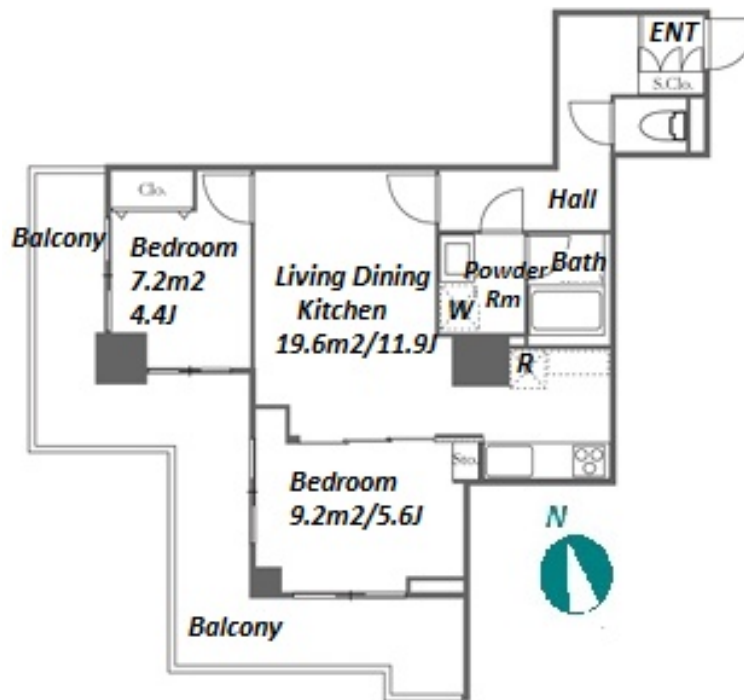

Lease Conditions			
LAYOUT	2 BR		
SIZE	52.18 m²/561.66 ft²		
RENT	JPY 243,000 / month		
Management Fee	JPY10,000/month		
Deposit	2 months	Key Money	1 month
Lease Term	Standard lease for 24 months		
Available	End, Apr, 2024		
Renewal Fee	1 month		
Agent Fee	1 month + tax		
Other Info	Key Replacement Fee : JPY15,000 Tax not included / Guarantor Company : TBC / Auto lock / Air-Con / Separated Toilet / Balcony / Nice Views / Flooring / Bathroom dryer / 2 Car Parks / Corner Unit		

Building Information			
Completion	Jun, 1995	Earthquake Resistance	New
Structure	SRC, 35 story		
Car Parking	for 1 space JPY35,800 + tax / month		
Bicycle Parking	TBC		
Music Instrument	-	Pet	N/A
Facilities	Motorcycle Parking (TBC) / Trunk Room (JPY20,000 + tax / month) / Within 20 min to Tokyo station by car / Near Large Parks / Janitor / Delivery box / Elevator / Security / High-rise		

Remarks
Renters Insurance : Required / Parking : 3 months deposit

*The actual Layout & Size may differ slightly from this floor plans & pictures.



HOUSEREP TOKYO INC.

ハウスレップトーキョー株式会社

#301, 1-4-15, Hiroo, Shibuya-ku, Tokyo 150-0012, Japan

+81 (0)3 6427 5860

inquiry@houserep-tokyo.com

Transaction Type : Intermediate

Agent Fee : 1 month + tax

Website : www.houserep-tokyo.com

