

Property Name	PARK AXIS MONZENNAKACHO EAST	Unit No.	TYPE	Access	Monnzennnakachou Station on Oedo Line (5 min) Monnzennnakachou Station on Tozai Line (5 min) Kiba Station on Tozai Line (5 min)
		1301	Apt.		
Address	2-11-20, Tomioka, Koto-Ku, Tokyo				

Mid-rise Apt. in Monzennakacho, easy access to Otemachi / Roppongi / Shinjuku

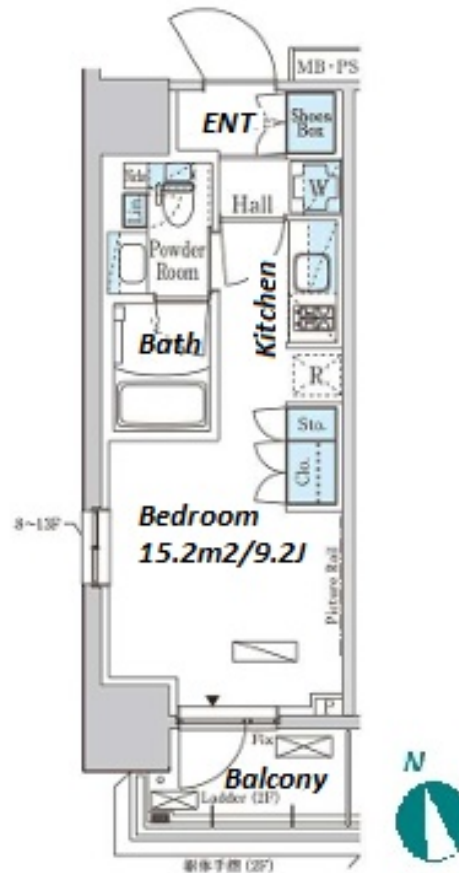

Lease Conditions			
LAYOUT	Studio		
SIZE	25.44 m²/273.83 ft²		
RENT	JPY 125,000 / month		
Management Fee	JPY10,000/month		
Deposit	2 months	Key Money	1 month
Lease Term	Standard lease for 24 months		
Available	Early, Jun, 2024		
Renewal Fee	1 month		
Agent Fee	1 month + tax		
Other Info	Key Replacement Fee : JPY20,000 Tax not included / Guarantor Company : TBC / Auto lock / Air-Con / Separated Toilet / Balcony / Penalty Fee for Early Cancellation / Musical Instrument Negotiable / CS/CATV / Flooring / Bathroom dryer		

Building Information			
Completion	Nov, 2020	Earthquake Resistance	New
Structure	RC, 13 story		
Car Parking	N/A		
Bicycle Parking	for 1 space ( Included )		
Music Instrument	Negotiable	Pet	Allowed
Facilities	Delivery box / Elevator / Newly-built (~7 y/o)		

\*The actual Layout & Size may differ slightly from this floor plans & pictures.



HOUSE REP TOKYO INC.

ハウスレップトーキョー株式会社

#301, 1-4-15, Hiroo, Shibuya-ku, Tokyo 150-0012, Japan

+81 (0)3 6427 5860

inquiry@houserep-tokyo.com

Transaction Type : Intermediate

Agent Fee : 1 month + tax

Website : www.houserep-tokyo.com



Remarks
Renters Insurance : Required / Pet:additional deposit ( 1 month ) / Pet : a small dog or a cat