

FOR RENT

Property ID No. :153658

HOUSEREP TOKYO INC.

Website : www.houserep-tokyo.com

Property Name	LUMILACE TOYOSU	Unit No.	TYPE	Access	Toyosu Station on Yurakucho Line (2 min)
		1108	Apt.		
Address	5-5-18, Toyosu, Koto-Ku, Tokyo				

Stylish Mid-rise Apt. in Toyosu

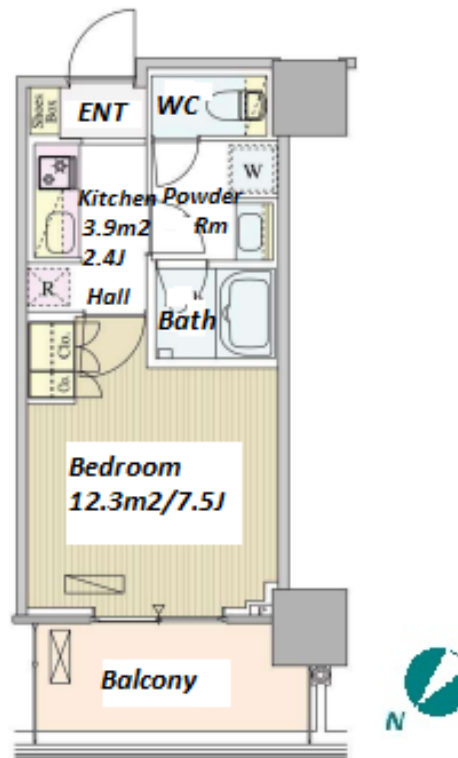

Lease Conditions			
LAYOUT	Studio		
SIZE	25.55 m²/275.01 ft²		
RENT	JPY 126,000 / month		
Management Fee	JPY10,000/month		
Deposit	2 months	Key Money	2 months
Lease Term	Standard lease for 24 months		
Available	End, Jun, 2024		
Renewal Fee	1 month		
Agent Fee	1 month + tax		
Other Info	Key Replacement Fee : JPY20,000 Tax not included / Guarantor Company : TBC / Auto lock / Air-Con / Separated Toilet / Balcony / Penalty Fee for Early Cancellation / Flooring / Bathroom dryer		

Building Information			
Completion	Jan, 2016	Earthquake Resistance	New
Structure	RC, 17 story		
Car Parking	N/A		
Bicycle Parking	for 1 space (Included)		
Music Instrument	-	Pet	-
Facilities	Motorcycle Parking (TBC) / Near Large Parks / Front desk / Concierge / Delivery box / Elevator		

*The actual Layout & Size may differ slightly from this floor plans & pictures.



HOUSEREP TOKYO INC.

ハウスレップトーキョー株式会社

#301, 1-4-15, Hiroo, Shibuya-ku, Tokyo 150-0012, Japan

+81 (0)3 6427 5860

inquiry@houserep-tokyo.com

Transaction Type : Intermediate

Agent Fee : 1 month + tax

Website : www.houserep-tokyo.com



Remarks
Renters Insurance : Required