

Property Name	YOYOGI HILL CREST	Unit No.	TYPE	Access	Yoyogikouenn Station on Chiyoda Line (7 min) Yoyogihachimann Station on Odakyu Line (8 min)
		3F	Apt.		
Address	5-34-4, Yoyogi, Shibuya-Ku, Tokyo				

Stylish Low Rise Apt. in Yoyogi, near Yoyogi Park / Shibuya

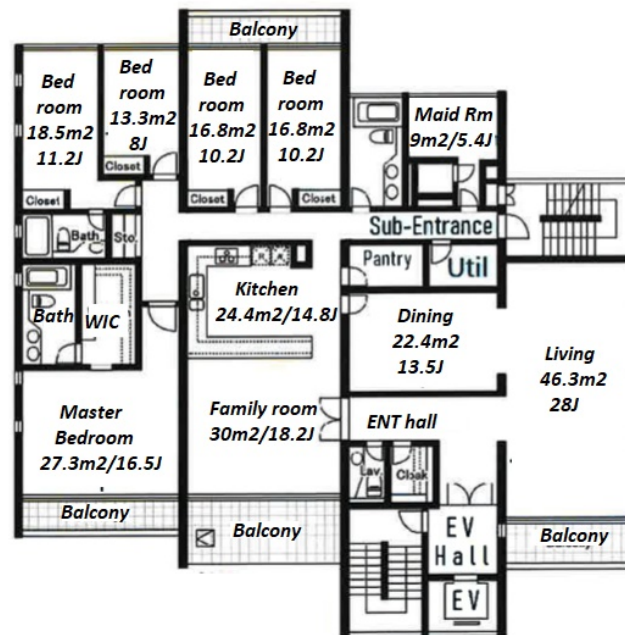

Lease Conditions			
LAYOUT	5 BR+F+M		
SIZE	328.9 m²/3540.24 ft²		
RENT	JPY 1,500,000 / month		
Management Fee	-		
Deposit	4 months	Key Money	1 month
Lease Term	Fixed term lease for 24 months		
Available	Negotiable		
Renewal Fee	-		
Agent Fee	1 month + tax		
Other Info	Auto lock / Fridge / Air-Con / Balcony / 2+ bathrooms / Washer / Dryer / Dishwasher / Oven / WIC / 2 Toilets		

Building Information			
Completion	May, 2001	Earthquake Resistance	New
Structure	SRC, 4 story		
Car Parking	for 1 space (Included)		
Bicycle Parking	N/A		
Music Instrument	-	Pet	-
Facilities	Near Large Parks / Delivery box / Elevator		

*The actual Layout & Size may differ slightly from this floor plans & pictures.



HOUSEREP TOKYO INC.

ハウスレップトーキョー株式会社

#301, 1-4-15, Hiroo, Shibuya-ku, Tokyo 150-0012, Japan

+81 (0)3 6427 5860

inquiry@housserep-tokyo.com

Transaction Type : Intermediate

Agent Fee : 1 month + tax

Website : www.housserep-tokyo.com



Remarks
Renters Insurance : Required