

Property Name	OMOTESANDO HILLS	Unit No.	TYPE	Access	Omotesanndou Station on Ginza Line (2 min) Meijijinnguumaee harajuku Station on Chiyoda Line (3 min)
	ZELKOVA TERRACE	E410	Apt.		
Address	4-12-20, Jingumae, Shibuya-Ku, Tokyo				

Luxury Low-rise Apt. at Omotesando Hills

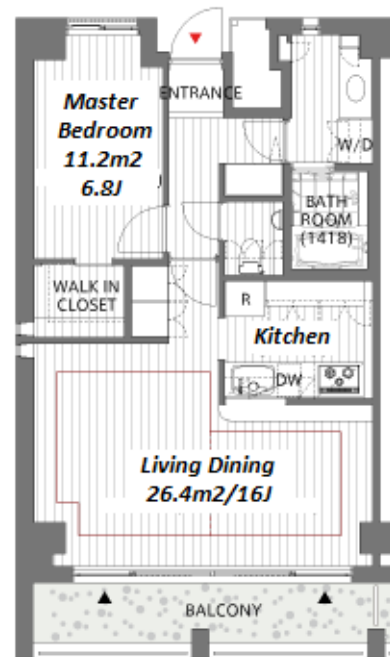

Lease Conditions		
LAYOUT	1 Room	
SIZE	46.04 m²/495.57 ft²	
RENT	JPY 440,000 / month	
Management Fee	-	
Deposit	4 months	Key Money -
Lease Term	Fixed term lease for 36 months	
Available	End, May, 2024	
Renewal Fee	-	
Agent Fee	1 month + tax	
Other Info	No Key Money / Auto lock / Fridge / Air-Con / Separated Toilet / Balcony / Washer / Dryer / Dishwasher / Oven	

Building Information			
Completion	Jan, 2006	Earthquake Resistance	New
Structure	SRC, 6 story		
Car Parking	TBC		
Bicycle Parking	TBC		
Music Instrument	-	Pet	Negotiable
Facilities	Motorcycle Parking (TBC) / Trunk Room ((Included)) / Near Large Parks / Delivery box / Elevator		

Remarks
Renters Insurance : Required

*The actual Layout & Size may differ slightly from this floor plans & pictures.



HOUSEREP TOKYO INC.

ハウスレップトーキョー株式会社

#301, 1-4-15, Hiroo, Shibuya-ku, Tokyo 150-0012, Japan

+81 (0)3 6427 5860

inquiry@houserep-tokyo.com

Transaction Type : Intermediate

Agent Fee : 1 month + tax

Website : www.houserep-tokyo.com

