

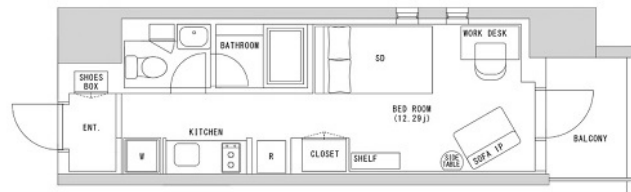

|               |                             |          |      |        |  |
|---------------|-----------------------------|----------|------|--------|--|
| Property Name | HMLET SUTENGUMAE            | Unit No. | TYPE | Access | Suitennguumae Station on Hanzomon Line (9 min)<br>Monnzennnakachou Station on Oedo Line (9 min)<br>Kiyosumishirakawa Station on Hanzomon Line (12 min) |
|               |                             | 1Studio  | Apt. |        |  |
| Address       | 2-8-6, Saga, Koto-Ku, Tokyo |          |      |        |  |

A tranquil space surrounded by history and culture in the Suitengu area



※ Price for monthly rent may vary based on lease periods, seasons, floor levels, etc.

\*The actual Layout & Size may differ slightly from this floor plans & pictures.



## HOUSEREP TOKYO INC.

ハウスレップトーキョー株式会社

#301, 1-4-15, Hiroo, Shibuya-ku, Tokyo 150-0012, Japan  
+81 (0)3 6427 5860 inquiry@housserep-tokyo.com

Transaction Type : Intermediate  
Agent Fee : 1 month + tax

Website : www.housserep-tokyo.com



| Lease Conditions             |   |                       |     |
|------------------------------|---|-----------------------|-----|
| LAYOUT                       | Studio  |                       |     |
| SIZE                         | 26.1 m²/280.93 ft²  |                       |     |
| RENT                         | JPY 204,000 / month   |                       |     |
| Management Fee               | -   |                       |     |
| Deposit                      | -   | Key Money             | -   |
| Lease Term                   | -   |                       |     |
| Available                    | Negotiable  |                       |     |
| Renewal Fee                  | -   |                       |     |
| Agent Fee                    | 1 month + tax   |                       |     |
| Other Info                   | No Key Money / Auto lock / Fridge / Air-Con / Balcony / Internet Included / Short-term Lease / Furnished / Washer / Dryer / Bathroom dryer / Semi-furnished (Home Appliances) |                       |     |
| Building Information         |   |                       |     |
| Completion                   | Feb, 2023   | Earthquake Resistance | New |
| Structure                    | RC  |                       |     |
| Car Parking                  | extra charge  |                       |     |
| Bicycle Parking              | extra charge  |                       |     |
| Music Instrument             | -   | Pet                   | -   |
| Facilities                   | Delivery box / 24h Garbage Drop-off / Newly-built (~7 y/o)  |                       |     |
| Remarks                      |   |                       |     |
| Renters Insurance : Required |   |                       |     |