

Property Name	LA TOUR SHINJUKU GARDEN	Unit No.	TYPE	Access	Takadanobaba Station on JR Yamanote Line (7 min) Shinnookubo Station on JR Yamanote Line (10 min)
		3708	Apt.		
Address	3-8-3, Okubo, Shinjuku-Ku, Tokyo				

Luxury Tower Residence in Shinjuku area, near Korea Town

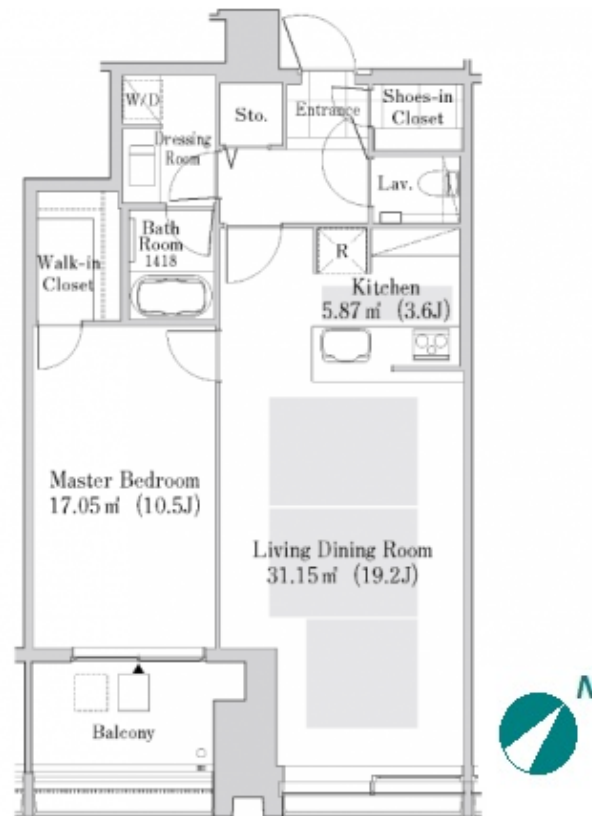

*The actual Layout & Size may differ slightly from this floor plans & pictures.

Lease Conditions			
LAYOUT	1 BR		
SIZE	74.46 m²/801.48 ft²		
RENT	JPY 510,000 / month		
Management Fee	-		
Deposit	2 months	Key Money	-
Lease Term	Fixed term lease for 36 months		
Available	End, May, 2024		
Renewal Fee	-		
Agent Fee	1 month + tax		
Other Info	Depreciation : 1 month / No Key Money / Auto lock / Air-Con / Separated Toilet / Balcony / Penalty Fee for Early Cancellation / Flooring / Floor Heating / Dishwasher / Bathroom dryer / WIC		
Building Information			
Completion	Mar, 2016	Earthquake Resistance	New
Structure	SRC, 37 story		
Car Parking	JPY35,000 ~ 60,000/ month		
Bicycle Parking	extra charge		
Music Instrument	-	Pet	Allowed
Facilities	Motorcycle Parking (TBC) / Trunk Room (extra charge) / Gym ((Included)) / Near Large Parks / Front desk / Concierge / Elevator / Sky lounge / High-rise		

Remarks
Renters Insurance : Required / Pet:additional deposit (1 month)



HOUSEREP TOKYO INC.

ハウスレップトーキョー株式会社

#301, 1-4-15, Hiroo, Shibuya-ku, Tokyo 150-0012, Japan

+81 (0)3 6427 5860 inquiry@housserep-tokyo.com

Transaction Type : Intermediate

Agent Fee : 1 month + tax

Website : www.housserep-tokyo.com

