

| | | | | | |
|---------------|---------------------------------|----------|------|--------|--|
| Property Name | PARK AXIS KINSHICHO WEST | Unit No. | TYPE | Access | Kikukawa Station on Toei Shinjuku Line (8 min) Kinshichou Station on JR Chuo-Sobu Line (11 min) |
| | | 302 | Apt. | | |
| Address | 4-4-5, Midori, Sumida-Ku, Tokyo | | | | |

Pet friendly Apt. near Sarue Onshi Park & JR Kinshicho station

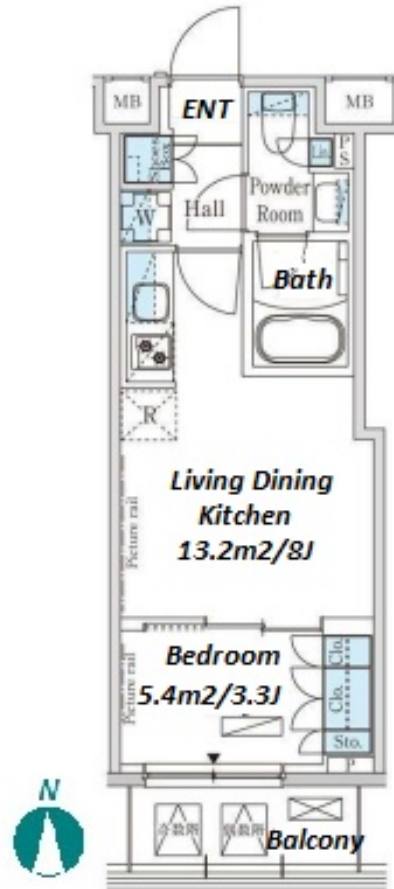

*The actual Layout & Size may differ slightly from this floor plans & pictures.

| Lease Conditions | | |
|------------------|--|-------------|
| LAYOUT | 1 BR | |
| SIZE | 28.09 m²/302.35 ft² | |
| RENT | JPY 129,000 / month | |
| Management Fee | JPY20,000/month | |
| Deposit | 1 month | Key Money - |
| Lease Term | Standard lease for 24 months | |
| Available | Early, May, 2024 | |
| Renewal Fee | 1 month | |
| Agent Fee | 1 month + tax | |
| Other Info | Key Replacement Fee : JPY20,000 Tax not included / Guarantor Company : TBC / No Key Money / Free rent / Auto lock / Air-Con / Separated Toilet / Balcony / Internet (Extra Charge) / Penalty Fee for Early Cancellation / Musical Instrument Negotiable / CS/CATV / Flooring / Bathroom dryer | |

| Building Information | | | |
|----------------------|--|-----------------------|---------|
| Completion | Mar, 2019 | Earthquake Resistance | New |
| Structure | RC, 9 story | | |
| Car Parking | extra charge | | |
| Bicycle Parking | TBC | | |
| Music Instrument | Negotiable | Pet | Allowed |
| Facilities | Motorcycle Parking (TBC) / Near Large Parks / Janitor / Delivery box / Elevator | | |

| Remarks |
|---|
| Renters Insurance : Required / Pet:additional deposit (1 month) / Pet : a small dog or a cat |



HOUSE REP TOKYO INC.

ハウズレップトーキョー株式会社

#301, 1-4-15, Hiroo, Shibuya-ku, Tokyo 150-0012, Japan

+81 (0)3 6427 5860 inquiry@housserep-tokyo.com

Transaction Type : Intermediate

Agent Fee : 1 month + tax

Website : www.housserep-tokyo.com

