

FOR RENT

Property ID No. :153157

HOUSEREP TOKYO INC.

Website : www.houserep-tokyo.com

Property Name	RIVER CITY 21 EAST TOWERS 10	Unit No.	TYPE	Access	Tsukishima Station on Oedo Line (5 min) Tsukishima Station on Yurakucho Line (7 min) Hacchoubori Station on Hibiya Line (13 min)
		2604	Apt.		
Address	2-2-10, Tsukuda, Chuo-Ku, Tokyo				

Renovated Waterfront Apt. in Tsukishima, Tokyo Bay Area

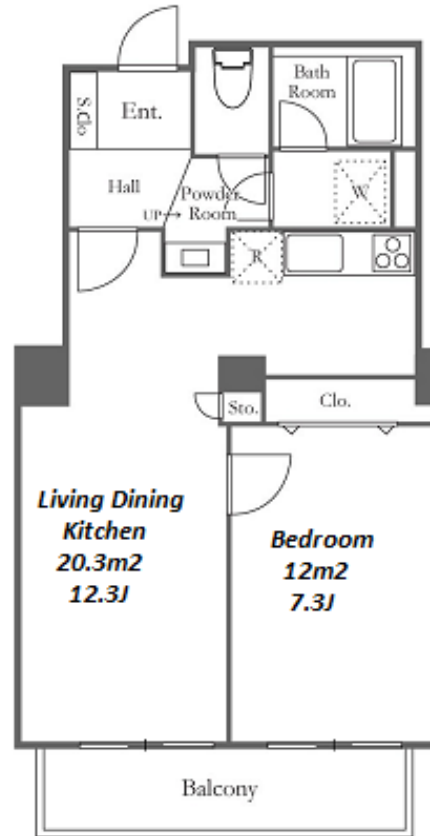

*The actual Layout & Size may differ slightly from this floor plans & pictures.



HOUSEREP TOKYO INC.

ハウズレップトーキョー株式会社

#301, 1-4-15, Hiroo, Shibuya-ku, Tokyo 150-0012, Japan

+81 (0)3 6427 5860

inquiry@houserep-tokyo.com

Transaction Type : Intermediate

Agent Fee : 1 month + tax

Website : www.houserep-tokyo.com



Lease Conditions			
LAYOUT	1 BR		
SIZE	48.78 m²/525.06 ft²		
RENT	JPY 199,000 / month		
Management Fee	JPY10,000/month		
Deposit	2 months	Key Money	-
Lease Term	Standard lease for 24 months		
Available	End, Apr, 2024		
Renewal Fee	1 month		
Agent Fee	1 month + tax		
Other Info	Key Replacement Fee : JPY15,000 Tax not included / Guarantor Company : TBC / No Key Money / Auto lock / Renovated / Air-Con / Separated Toilet / Balcony / Penalty Fee for Early Cancellation / Nice Views / Flooring / IH Stoves / Bathroom dryer		
Building Information			
Completion	Mar, 1991	Earthquake Resistance	New
Structure	SRC, 37 story		
Car Parking	JPY30,000 + tax / month		
Bicycle Parking	TBC		
Music Instrument	-	Pet	N/A
Facilities	Motorcycle Parking (TBC) / Trunk Room ((Included)) / Within 20 min to Tokyo station by car / Near Large Parks / Janitor / Delivery box / Elevator / High-rise		
Remarks			
Renters Insurance : Required / Parking : 3 months deposit / Apr.2022 renovated			