

Property Name	RISE YOYOGI III	Unit No.	TYPE	Access	Minamishinnjuku Station on Odakyu Line (5 min) Yoyogi Station on Oedo Line (5 min) Yoyogi Station on JR Yamanote Line (6 min)
		205	Apt.		
Address	1-8-2, Yoyogi, Shibuya-Ku, Tokyo				

Modern Low Rise Apt. in Yoyogi Area, near Meiji-jingu

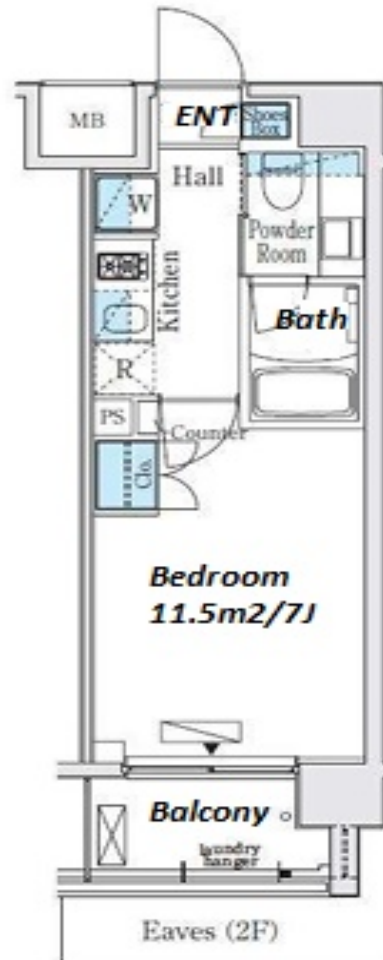

Lease Conditions		
LAYOUT	Studio	
SIZE	22.72 m²/244.55 ft²	
RENT	JPY 123,000 / month	
Management Fee	JPY10,000/month	
Deposit	2 months	Key Money -
Lease Term	Standard lease for 24 months	
Available	End, Mar, 2024	
Renewal Fee	1 month	
Agent Fee	1 month + tax	
Other Info	Key Replacement Fee : JPY20,000 Tax not included / Guarantor Company : TBC / No Key Money / Auto lock / Air-Con / Separated Toilet / Balcony / Internet (Extra Charge) / Penalty Fee for Early Cancellation / Flooring / Bathroom dryer	

Building Information			
Completion	Jan, 2020	Earthquake Resistance	New
Structure	RC, 6 story		
Car Parking	N/A		
Bicycle Parking	for 1 space (Included)		
Music Instrument	-	Pet	-
Facilities	Motorcycle Parking (JPY3,000 + tax / month) / Janitor / Delivery box / Elevator / Newly-built (~7 y/o)		

Remarks
Renters Insurance : Required

*The actual Layout & Size may differ slightly from this floor plans & pictures.



HOUSEREP TOKYO INC.

ハウズレップトーキョー株式会社

#301, 1-4-15, Hiroo, Shibuya-ku, Tokyo 150-0012, Japan

+81 (0)3 6427 5860 inquiry@houserep-tokyo.com

Transaction Type : Intermediate

Agent Fee : 1 month + tax

Website : www.houserep-tokyo.com

