

Property Name	RESIDIA GOTENYAMA	Unit No.	TYPE	Access	Kitashinagawa Station on Keikyu Line (9 min) Oosaki Station on JR Shonan Shinjuku Line (14 min) Shinagawa Station on JR Yamanote Line (14 min)
		303	Apt.		
Address	5-15-9, Kitashinagawa, Shinagawa-Ku, Tokyo				

## Low Rise Apt. in Peaceful Residential Area in Shinagawa

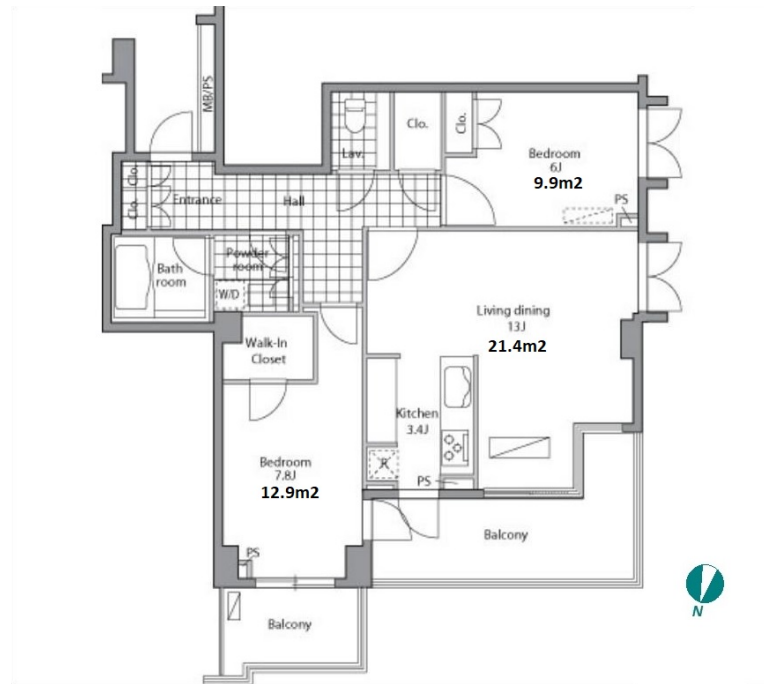
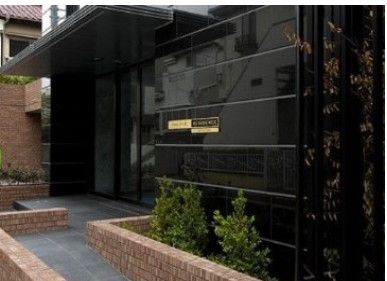

\*The actual Layout & Size may differ slightly from this floor plans & pictures.

Lease Conditions		
LAYOUT	2 BR	
SIZE	73.18 m²/787.7 ft²	
RENT	JPY 340,000 / month	
Management Fee	JPY15,000/month	
Deposit	2 months	Key Money -
Lease Term	Standard lease for 24 months	
Available	Now	
Renewal Fee	1 month	
Agent Fee	1 month + tax	
Other Info	Key Replacement Fee : JPY18,000 Tax not included / Guarantor Company : TBC / No Key Money / Auto lock / Air-Con / Separated Toilet / Balcony / Penalty Fee for Early Cancellation / CS/CATV / Flooring / Floor Heating / Bathroom dryer	

Building Information			
Completion	Mar, 2007	Earthquake Resistance	New
Structure	RC, 3 story		
Car Parking	TBC		
Bicycle Parking	TBC		
Music Instrument	-	Pet	Negotiable
Facilities	Motorcycle Parking (TBC) / Trunk Room (TBC) / Within 20 min to Roppongi by train / Within 20 min to Tokyo station by car / Near Large Parks / Delivery box / Elevator		

Remarks
Renters Insurance : Required



HOUSEREP TOKYO INC.

ハウスレップトーキョー株式会社

#301, 1-4-15, Hiroo, Shibuya-ku, Tokyo 150-0012, Japan

+81 (0)3 6427 5860 inquiry@housserep-tokyo.com

Transaction Type : Intermediate

Agent Fee : 1 month + tax

Website : www.housserep-tokyo.com

