

FOR RENT

Property ID No. :152800

HOUSEREP TOKYO INC.

Website : www.housserep-tokyo.com

| | | | | | |
|---------------|-------------------------------------|----------|------|--------|--|
| Property Name | JP NOIE KINSHICHO | Unit No. | TYPE | Access | Kinnsichou Station on JR Chuo-Sobu Line (9 min) Kinnsichou Station on Hanzomon Line (9 min) Ryougoku Station on Oedo Line (11 min) |
| | | 305 | Apt. | | |
| Address | 4-15-18, Kamezawa, Sumida-Ku, Tokyo | | | | |

Modern Apt. near lively Kinshicho district

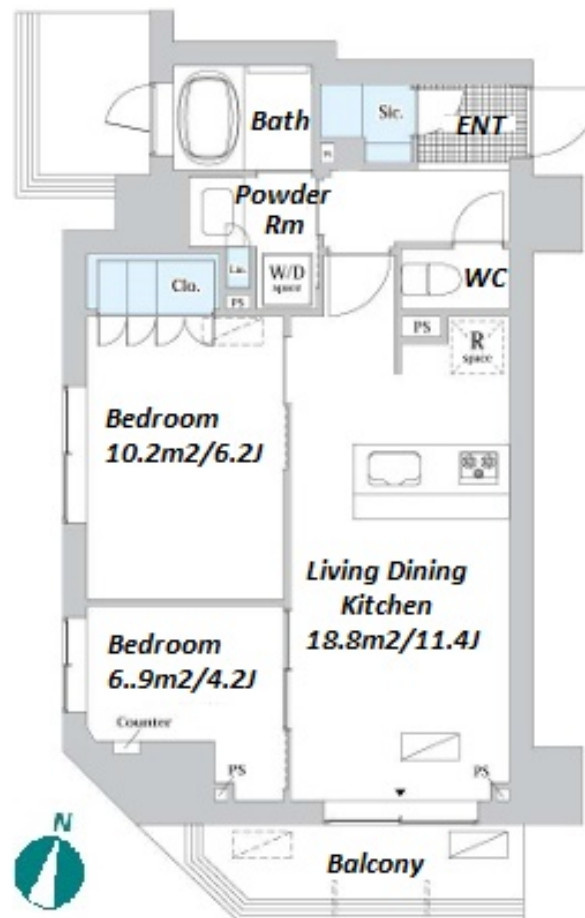

*The actual Layout & Size may differ slightly from this floor plans & pictures.

| Lease Conditions | | | |
|------------------|---|-----------|---------|
| LAYOUT | 2 BR | | |
| SIZE | 50.51 m²/543.68 ft² | | |
| RENT | JPY 221,000 / month | | |
| Management Fee | JPY15,000/month | | |
| Deposit | 2 months | Key Money | 1 month |
| Lease Term | Standard lease for 24 months | | |
| Available | Early, Apr, 2024 | | |
| Renewal Fee | 1 month | | |
| Agent Fee | 1 month + tax | | |
| Other Info | Key Replacement Fee : JPY20,000 Tax not included / Guarantor Company : TBC / Auto lock / Air-Con / Separated Toilet / Balcony / CS/CATV / Flooring / IH Stoves / Bathroom dryer | | |

| Building Information | | | |
|----------------------|--|-----------------------|-----|
| Completion | Aug, 2021 | Earthquake Resistance | New |
| Structure | RC, 9 story | | |
| Car Parking | N/A | | |
| Bicycle Parking | for 1 space (Included) | | |
| Music Instrument | - | Pet | N/A |
| Facilities | Motorcycle Parking (TBC) / Trunk Room (TBC) / Near Large Parks / Janitor / Delivery box / Elevator | | |

| Remarks |
|------------------------------|
| Renters Insurance : Required |



HOUSEREP TOKYO INC.

ハウスレップトーキョー株式会社

#301, 1-4-15, Hiroo, Shibuya-ku, Tokyo 150-0012, Japan

+81 (0)3 6427 5860

inquiry@housserep-tokyo.com

Transaction Type : Intermediate

Agent Fee : 1 month + tax

Website : www.housserep-tokyo.com

