

Property Name	LA REINA ICHIGAYA KAGACHO	Unit No.	TYPE	Access	Ushigomeyanagichou Station on Oedo Line (7 min) Akebonobashi Station on Toei Shinjuku Line (11 min)
		101	Apt.		
Address	2-2-10, Ichigayakagacho, Shinjuku-Ku, Tokyo				

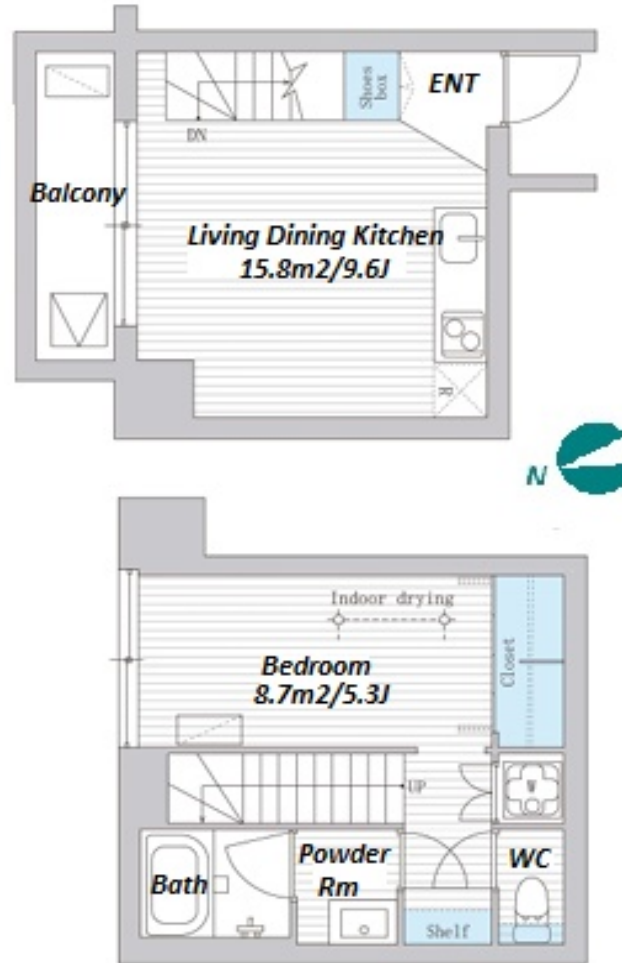

Lease Conditions			
LAYOUT	1 BR		
SIZE	40.7 m²/438.09 ft²		
RENT	JPY 154,000 / month		
Management Fee	JPY10,000/month		
Deposit	2 months	Key Money	-
Lease Term	Standard lease for 24 months		
Available	End, Mar, 2024		
Renewal Fee	1 month		
Agent Fee	1 month + tax		
Other Info	Key Replacement Fee : JPY20,000 Tax not included / Guarantor Company : TBC / No Key Money / Auto lock / Air-Con / Separated Toilet / Balcony / Loft/Maisonnette / Penalty Fee for Early Cancellation / Flooring / Bathroom dryer		

Building Information			
Completion	Apr, 2020	Earthquake Resistance	New
Structure	RC, 6 story		
Car Parking	-		
Bicycle Parking	for 1 space ( Included )		
Music Instrument	-	Pet	-
Facilities	Trunk Room (( Included )) / Janitor / Delivery box / Elevator / Newly-built (~7 y/o)		

\*The actual Layout & Size may differ slightly from this floor plans & pictures.



# HOUSEREP TOKYO INC.

ハウスレップトーキョー株式会社

#301, 1-4-15, Hiroo, Shibuya-ku, Tokyo 150-0012, Japan

+81 (0)3 6427 5860 inquiry@housserep-tokyo.com

Transaction Type : Intermediate

Agent Fee : 1 month + tax

Website : www.housserep-tokyo.com



Remarks
Renters Insurance : Required