

Property Name	URBANEX NISHISHINJUKU II	Unit No.	TYPE	Access	Ookubo Station on JR Chuo-Sobu Line (4 min)
		304	Apt.		Shinnjukunishiguchi Station on Oedo Line (7 min)
Address	1-2-17, Kitashinjuku, Shinjuku-Ku, Tokyo				Nishishinnjuku Station on Marunouchi Line (8 min)
					Shinnjuku Station on JR Yamanote Line (12 min)

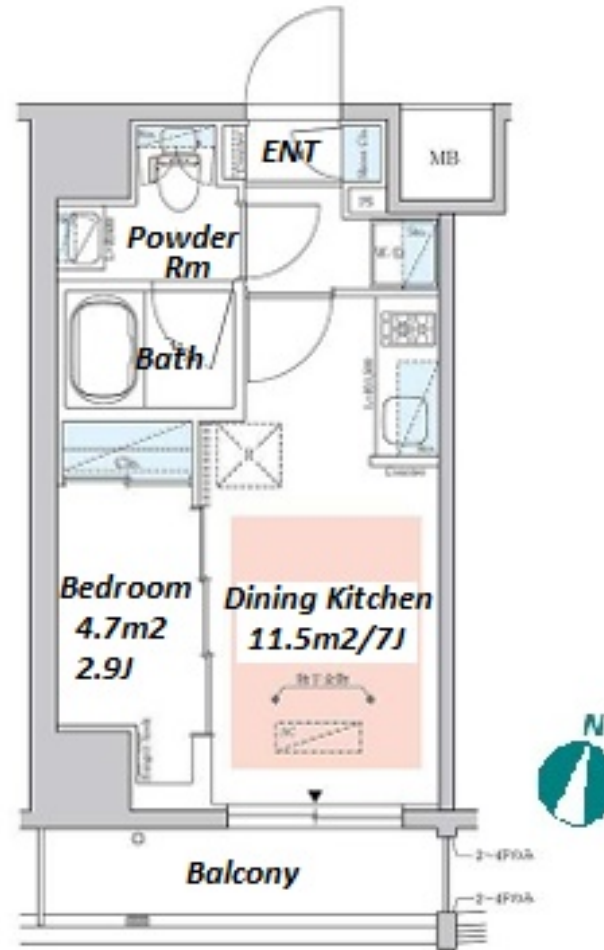

*The actual Layout & Size may differ slightly from this floor plans & pictures.

Lease Conditions

LAYOUT	1 BR		
SIZE	25.34 m²/272.75 ft²		
RENT	JPY 144,000 / month		
Management Fee	JPY15,000/month		
Deposit	2 months	Key Money	-
Lease Term	Standard lease for 24 months		
Available	End, Apr, 2024		
Renewal Fee	1 month		
Agent Fee	1 month + tax		
Other Info	Key Replacement Fee : JPY20,000 Tax not included / Guarantor Company : TBC / No Key Money / Auto lock / Air-Con / Separated Toilet / Balcony / Penalty Fee for Early Cancellation / Flooring / Floor Heating / Bathroom dryer		

Building Information

Completion	Aug, 2021	Earthquake Resistance	New
Structure	RC, 14 story		
Car Parking	N/A		
Bicycle Parking	for 1 space JPY500 + tax / month		
Music Instrument	-	Pet	-
Facilities	Motorcycle Parking (TBC) / Delivery box / Elevator		

Remarks

Renters Insurance : Required



HOUSEREP TOKYO INC.

ハウスレップトーキョー株式会社

#301, 1-4-15, Hiroo, Shibuya-ku, Tokyo 150-0012, Japan

+81 (0)3 6427 5860

inquiry@houserep-tokyo.com

Transaction Type : Intermediate

Agent Fee : 1 month + tax

Website : www.houserep-tokyo.com

