

FOR RENT

Property ID No. :152568

HOUSEREP TOKYO INC.

Website : www.housserep-tokyo.com

| | | | | | |
|---------------|---|----------|------|--------|--|
| Property Name | RESIDIA TOWER KAMI-IKEBUKURO(TOWER) | Unit No. | TYPE | Access | Ootsuka Station on JR Yamanote Line (9 min) Nishisugamo Station on Mita Line (12 min) |
| | | TW-423 | Apt. | | |
| Address | 1-37-22, Kamiikebukuro, Toshima-Ku, Tokyo | | | | |

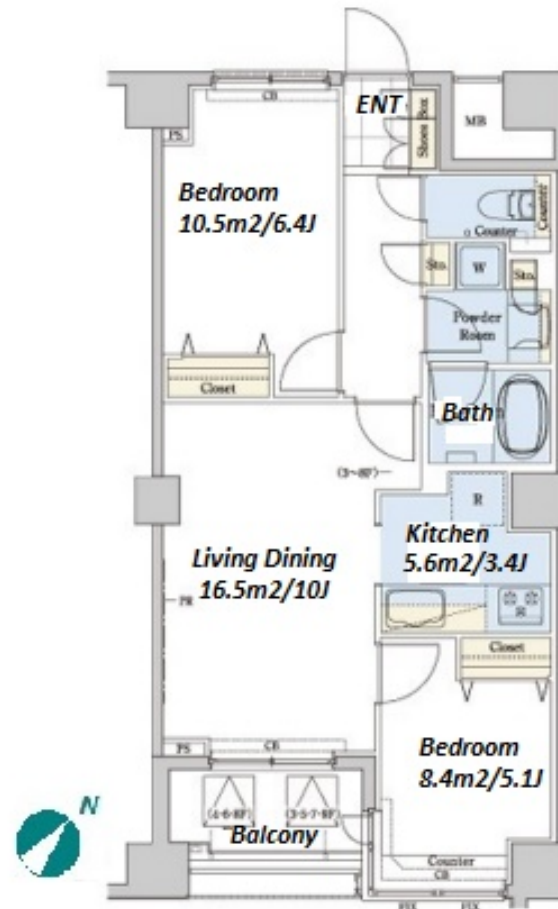

Lease Conditions

| | | | |
|----------------|--|-----------|---|
| LAYOUT | 2 BR | | |
| SIZE | 55.98 m²/602.56 ft² | | |
| RENT | JPY 245,000 / month | | |
| Management Fee | JPY15,000/month | | |
| Deposit | 1 month | Key Money | - |
| Lease Term | Fixed term lease for 36 months | | |
| Available | End, Apr, 2024 | | |
| Renewal Fee | - | | |
| Agent Fee | 1 month + tax | | |
| Other Info | Key Replacement Fee : JPY20,000 Tax not included / Guarantor Company : TBC / No Key Money / Auto lock / Air-Con / Separated Toilet / Balcony / Internet (Extra Charge) / Penalty Fee for Early Cancellation / Musical Instrument Negotiable / CS/CATV / Flooring / Bathroom dryer | | |

Building Information

| | | | |
|------------------|---|-----------------------|---------|
| Completion | May, 2009 | Earthquake Resistance | New |
| Structure | RC, 22 story | | |
| Car Parking | JPY25,000 ~ 39,000 + tax / month | | |
| Bicycle Parking | N/A | | |
| Music Instrument | Negotiable | Pet | Allowed |
| Facilities | Front desk / Delivery box / Elevator / Security / 24h Garbage Drop-off / High-rise | | |

Remarks

Fixed term lease : Re contract fee: 1 month of new rent / Internet fee:
JPY1,500+tax/month / Parking : 1 month for deposit / Pet:additional
deposit (1 month) / Pet : a small dog or a cat

*The actual Layout & Size may differ slightly from this floor plans & pictures.



HOUSEREP TOKYO INC.

ハウスレップトーキョー株式会社

#301, 1-4-15, Hiroo, Shibuya-ku, Tokyo 150-0012, Japan

+81 (0)3 6427 5860

inquiry@housserep-tokyo.com

Transaction Type : Intermediate

Agent Fee : 1 month + tax

Website : www.housserep-tokyo.com

