

Property Name	THE PARK HABIO KAMATA	Unit No.	TYPE	Access	Kamata Station on JR Keihin Tohoku Line (4 min) Kamata Station on Tokyu Ikegami Line (6 min) Keikyuukamata Station on Keikyu Line (8 min)
		902	Apt.		
Address	5-8-3, Kamata, Ota-Ku, Tokyo				

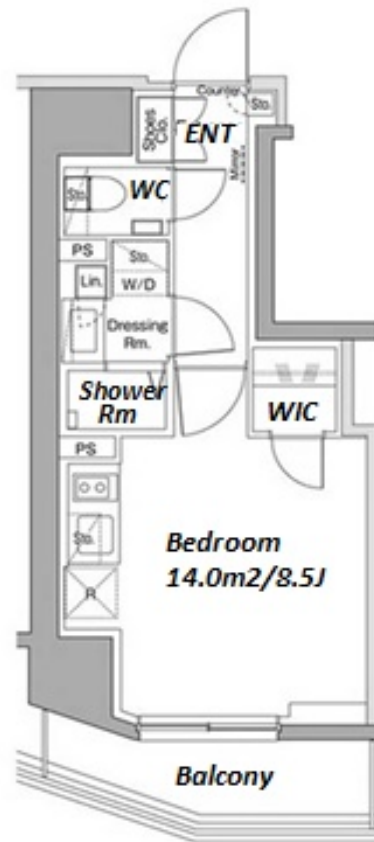

*The actual Layout & Size may differ slightly from this floor plans & pictures.

Lease Conditions			
LAYOUT	Studio		
SIZE	25.38 m²/273.18 ft²		
RENT	JPY 114,000 / month		
Management Fee	JPY15,000/month		
Deposit	2 months	Key Money	1 month
Lease Term	Standard lease for 24 months		
Available	Now		
Renewal Fee	1 month		
Agent Fee	1 month + tax		
Other Info	Key Replacement Fee : JPY20,000 Tax not included / Guarantor Company : TBC / Free rent / Auto lock / Air-Con / Separated Toilet / Balcony / Internet Included / Musical Instrument Negotiable / Flooring / Bathroom dryer / WIC		

Building Information			
Completion	Feb, 2020	Earthquake Resistance	New
Structure	RC, 11 story		
Car Parking	N/A		
Bicycle Parking	JPY300 + tax / month		
Music Instrument	Negotiable	Pet	Allowed
Facilities	Motorcycle Parking (TBC) / Delivery box / Elevator		

Remarks
Renters Insurance : Required / Pet:additional deposit (1 month) / Pet : a small dog or up to two cats



HOUSEREP TOKYO INC.

ハウスレップトーキョー株式会社

#301, 1-4-15, Hiroo, Shibuya-ku, Tokyo 150-0012, Japan

+81 (0)3 6427 5860 inquiry@housserep-tokyo.com

Transaction Type : Intermediate

Agent Fee : 1 month + tax

Website : www.housserep-tokyo.com

