

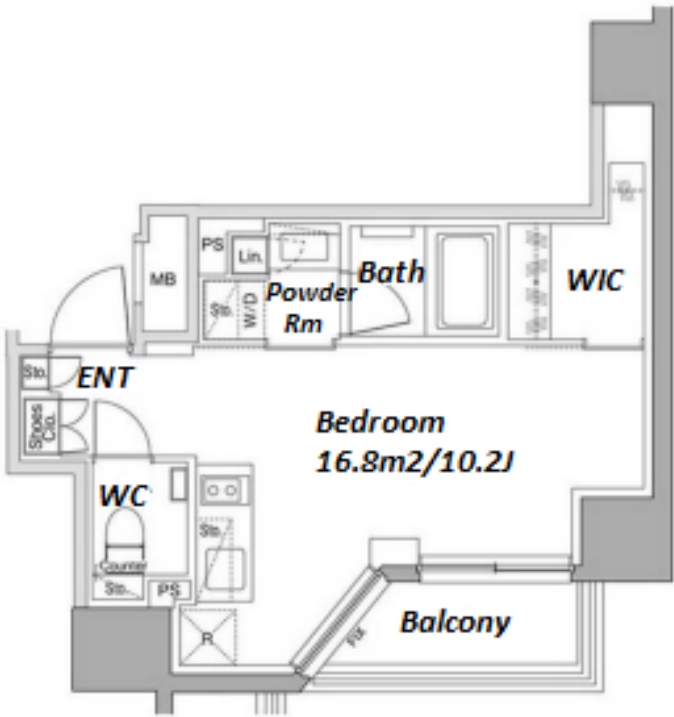

FOR RENT		Property ID No. :152429				HOUSEREP TOKYO INC.		Website : www.housserep-tokyo.com	
Property Name	THE PARK HABIO KAMATA		Unit No.	TYPE	Access	Kamata Station on JR Keihin Tohoku Line (4 min) Kamata Station on Tokyu Ikegami Line (6 min) Keikyuukamata Station on Keikyu Line (8 min)			
			405	Apt.					
Address	5-8-3, Kamata, Ota-Ku, Tokyo								



*The actual Layout & Size may differ slightly from this floor plans & pictures.



HOUSEREP TOKYO INC.
 ハウスレップトーキョー株式会社

#301, 1-4-15, Hiroo, Shibuya-ku, Tokyo 150-0012, Japan
 +81 (0)3 6427 5860 inquiry@housserep-tokyo.com

Transaction Type : Intermediate
 Agent Fee : 1 month + tax

 Website : www.housserep-tokyo.com



Lease Conditions		
LAYOUT	Studio	
SIZE	28.33 m²/304.94 ft²	
RENT	JPY 118,000 / month	
Management Fee	JPY10,000/month	
Deposit	2 months	Key Money -
Lease Term	Standard lease for 24 months	
Available	End, May, 2024	
Renewal Fee	1 month	
Agent Fee	1 month + tax	
Other Info	Key Replacement Fee : JPY20,000 Tax not included / Guarantor Company : TBC / No Key Money / Free rent / Auto lock / Air-Con / Separated Toilet / Balcony / Internet Included / Penalty Fee for Early Cancellation / Musical Instrument Negotiable / Flooring / Bathroom dryer / WIC	

Building Information			
Completion	Feb, 2020	Earthquake Resistance	New
Structure	RC, 11 story		
Car Parking	N/A		
Bicycle Parking	JPY300 + tax / month		
Music Instrument	Negotiable	Pet	Allowed
Facilities	Motorcycle Parking (JPY5,000 + tax / month) / Delivery box / Elevator		

Remarks
Renters Insuarance : Required / Pet:additional deposit (1 month) / Pet : a small dog or up to two cats