

Property Name	PARK AXIS YOKOHAMA ODORI KOEN	Unit No.	TYPE	Access	Isezakichoujamachi Station on Blue Line (4 min) Kannnai Station on JR Negishi Line (11 min)
		402	Apt.		
Address	3-5, Fujimicho, Naka-Ku, Yokohama-Shi, Kanagawa				

Stylish Mid Rise Apt. in Yokohama near Kannai stn.

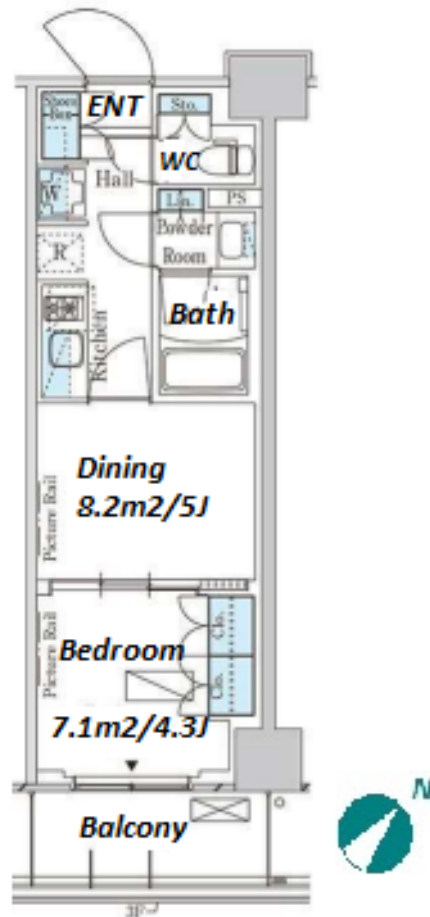

Lease Conditions		
LAYOUT	1 BR	
SIZE	30.4 m²/327.22 ft²	
RENT	JPY 116,000 / month	
Management Fee	JPY12,000/month	
Deposit	2 months	Key Money -
Lease Term	Standard lease for 24 months	
Available	End, Mar, 2024	
Renewal Fee	1 month	
Agent Fee	1 month + tax	
Other Info	Key Replacement Fee : JPY15,000 Tax not included / Guarantor Company : TBC / No Key Money / Free rent / Auto lock / Air-Con / Separated Toilet / Balcony / Internet Included / Penalty Fee for Early Cancellation / Musical Instrument Negotiable / CS/CATV / Flooring / Bathroom dryer	

Building Information			
Completion	Dec, 2020	Earthquake Resistance	New
Structure	RC, 10 story		
Car Parking	JPY28,000 + tax / month		
Bicycle Parking	TBC		
Music Instrument	Negotiable	Pet	Allowed
Facilities	Motorcycle Parking (TBC) / Near Large Parks / Delivery box / Elevator		

\*The actual Layout & Size may differ slightly from this floor plans & pictures.



HOUSEREP TOKYO INC.

ハウスレップトーキョー株式会社

#301, 1-4-15, Hiroo, Shibuya-ku, Tokyo 150-0012, Japan

+81 (0)3 6427 5860 inquiry@houserep-tokyo.com

Transaction Type : Intermediate

Agent Fee : 1 month + tax

Website : www.houserep-tokyo.com



Remarks
Renters Insurance : Required / Bicycle parking : Registration fee: JPY.1,000+tax / Pet:additional deposit ( 1 month ) / Pet : a small dog or a cat