

FOR RENT

Property ID No. :152412

HOUSEREP TOKYO INC.

Website : www.housserep-tokyo.com

Property Name	RESIDIA ICHIGAYA	Unit No.	TYPE	Access	Ichigaya Station on Namboku Line (5 min) Yotsuya Station on JR Chuo Line (6 min)
		506	Apt.		
Address	3-17, Ichigayahommuracho, Shinjuku-Ku, Tokyo				

Stylish Apt. in Ichigaya / Yotsuya

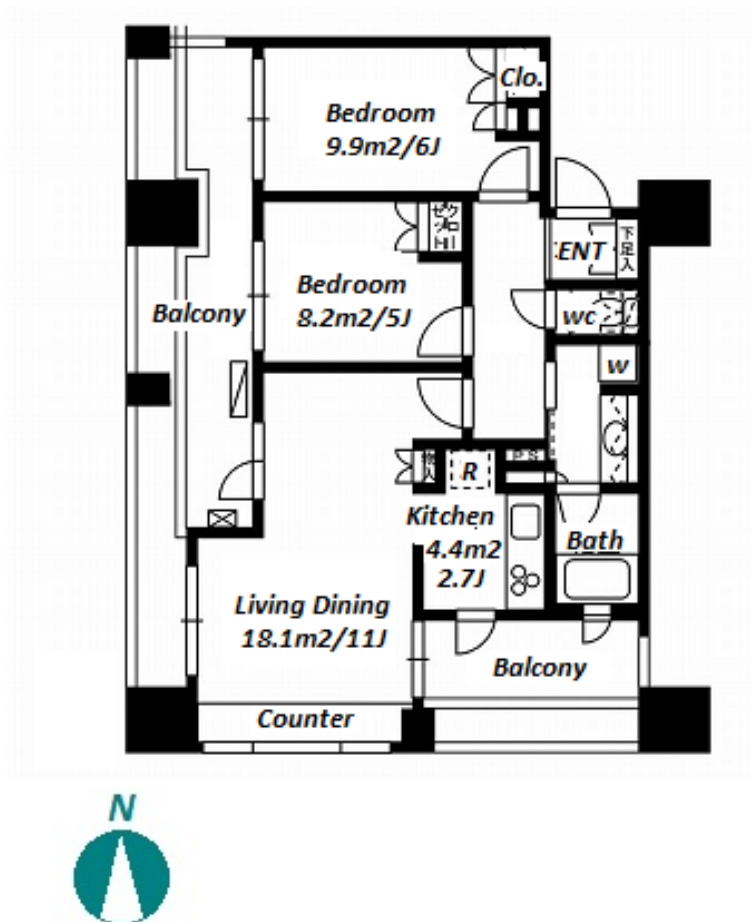

*The actual Layout & Size may differ slightly from this floor plans & pictures.

Lease Conditions			
LAYOUT	2 BR		
SIZE	56.5 m ² /608.16 ft ²		
RENT	JPY 265,000 / month		
Management Fee	JPY15,000/month		
Deposit	2 months	Key Money	1 month
Lease Term	Standard lease for 24 months		
Available	End, Apr, 2024		
Renewal Fee	1 month		
Agent Fee	1 month + tax		
Other Info	Key Replacement Fee : JPY18,000 Tax not included / Guarantor Company : TBC / Auto lock / Air-Con / Separated Toilet / Balcony / Penalty Fee for Early Cancellation / CS/CATV / Flooring / Bathroom dryer		

Building Information			
Completion	Sep, 2004	Earthquake Resistance	New
Structure	SRC, 14 story		
Car Parking	N/A		
Bicycle Parking	N/A		
Music Instrument	-	Pet	Allowed
Facilities	Motorcycle Parking (TBC) / Within 20 min to Tokyo station by car / Near Large Parks / French Community / Delivery box / Elevator		

Remarks
Tenant support fee: JPY.10,000+tax/2yrs. / Pet:additional deposit (1 month) / Pet : a small dog or a cat



HOUSEREP TOKYO INC.

ハウスレップトーキョー株式会社

#301, 1-4-15, Hiroo, Shibuya-ku, Tokyo 150-0012, Japan

+81 (0)3 6427 5860

inquiry@housserep-tokyo.com

Transaction Type : Intermediate

Agent Fee : 1 month + tax

Website : www.housserep-tokyo.com

