

Property Name	COOP NOMURA OTSUKA	Unit No.	TYPE	Access	Sugamoshinndenn Station on Toden Arawaka Line (5 min) Ootsuka Station on JR Yamanote Line (9 min) Kitaikebukuro Station on (10 min)
		905	Apt.		
Address	1-7-20, Nishisugamo, Toshima-Ku, Tokyo				

## Mid rise apartment in Sugamo area

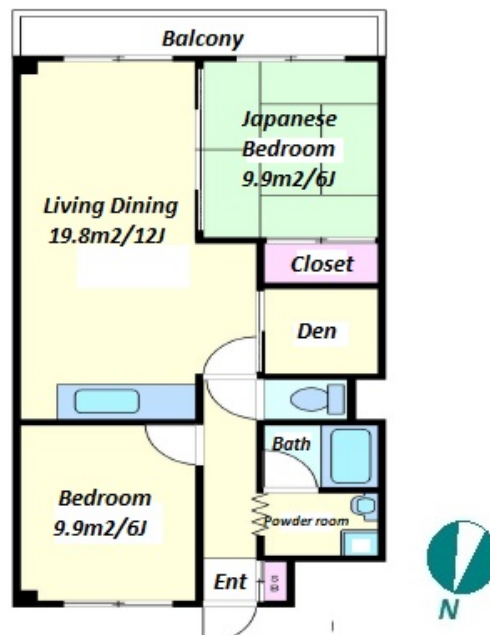

\*The actual Layout & Size may differ slightly from this floor plans & pictures.

Lease Conditions			
LAYOUT	2 BR		
SIZE	58.57 m²/630.44 ft²		
RENT	JPY 135,000 / month		
Management Fee	-		
Deposit	1 month	Key Money	1 month
Lease Term	Standard lease for 24 months		
Available	Negotiable		
Renewal Fee	1 month		
Agent Fee	1 month + tax		
Other Info	Key Replacement Fee : JPY17,000 Tax not included / Guarantor Company : TBC / Air-Con / Separated Toilet / Balcony / No Smoking / CS/CATV / Flooring		
Building Information			
Completion	Mar, 1978	Earthquake Resistance	Old
Structure	RC, 9 story		
Car Parking	JPY25,000 + tax / month		
Bicycle Parking	extra charge		
Music Instrument	-	Pet	
Facilities	Motorcycle Parking (extra charge) / Delivery box / Elevator		

Remarks
Renters Insurance : Required / Pet:additional deposit ( 1 month )



HOUSEREP TOKYO INC.

ハウスレップトーキョー株式会社

#301, 1-4-15, Hiroo, Shibuya-ku, Tokyo 150-0012, Japan

+81 (0)3 6427 5860

inquiry@houserep-tokyo.com

Transaction Type : Intermediate

Agent Fee : 1 month + tax

Website : www.houserep-tokyo.com

