

Property Name	ROYGENT SHIMURA SAKAUE	Unit No.	TYPE	Access	Shimurasakaue Station on Mita Line (13 min) Shimurasannchoume Station on Mita Line (13 min) Ukimafunado Station on JR Saikyo Line (17 min)
		227	Apt.		
Address	2-3-14, Higashisakashita, Itabashi-Ku, Tokyo				

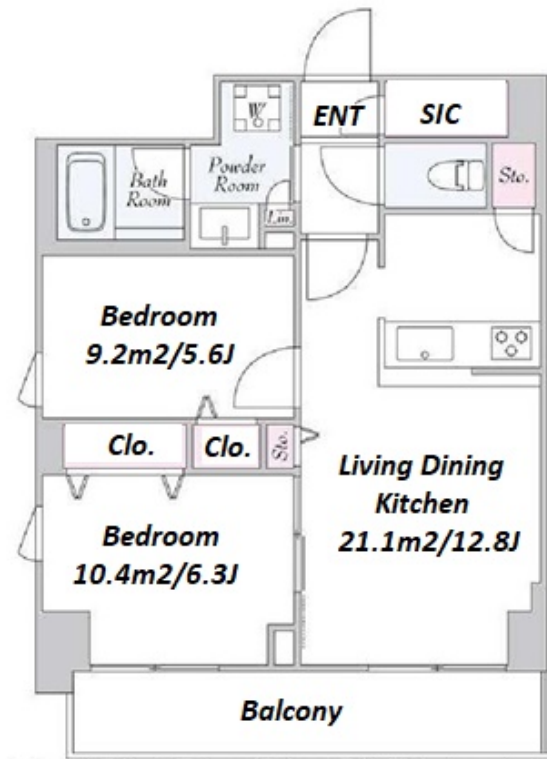

*The actual Layout & Size may differ slightly from this floor plans & pictures.

Lease Conditions			
LAYOUT	2 BR		
SIZE	55.88 m²/601.48 ft²		
RENT	JPY 179,000 / month		
Management Fee	JPY15,000/month		
Deposit	2 months	Key Money	1 month
Lease Term	Standard lease for 24 months		
Available	Now		
Renewal Fee	1 month		
Agent Fee	1 month + tax		
Other Info	Key Replacement Fee : JPY20,000 Tax not included / Auto lock / Air-Con / Separated Toilet / Balcony / Internet (Extra Charge) / Penalty Fee for Early Cancellation / Flooring / Bathroom dryer / Corner Unit		

Building Information			
Completion	Mar, 2022	Earthquake Resistance	New
Structure	RC, 7 story		
Car Parking	JPY18,000 + tax / month		
Bicycle Parking	for 1 space (Included)		
Music Instrument	-	Pet	N/A
Facilities	Motorcycle Parking (JPY2,000 + tax / month) / Delivery box / Elevator / Security / 24h Garbage Drop-off / Newly-built (~7 y/o)		

Remarks
Renters Insurance : Required / Parking : 1 month deposit



HOUSEREP TOKYO INC.

ハウスレップトーキョー株式会社

#301, 1-4-15, Hiroo, Shibuya-ku, Tokyo 150-0012, Japan

+81 (0)3 6427 5860

inquiry@houserrep-tokyo.com

Transaction Type : Intermediate

Agent Fee : 1 month + tax

Website : www.houserrep-tokyo.com

