

Property Name	GARDEN HARAJUKU	Unit No.	TYPE	Access	Meijijinnguumae harajuku Station on Chiyoda Line (6 min) Harajuku Station on JR Yamanote Line (10 min)
		406	Apt.		
Address	4-18-15, Jingumae, Shibuya-Ku, Tokyo				

Stylish Low Rise Apt. in Harajuku / Omotesando

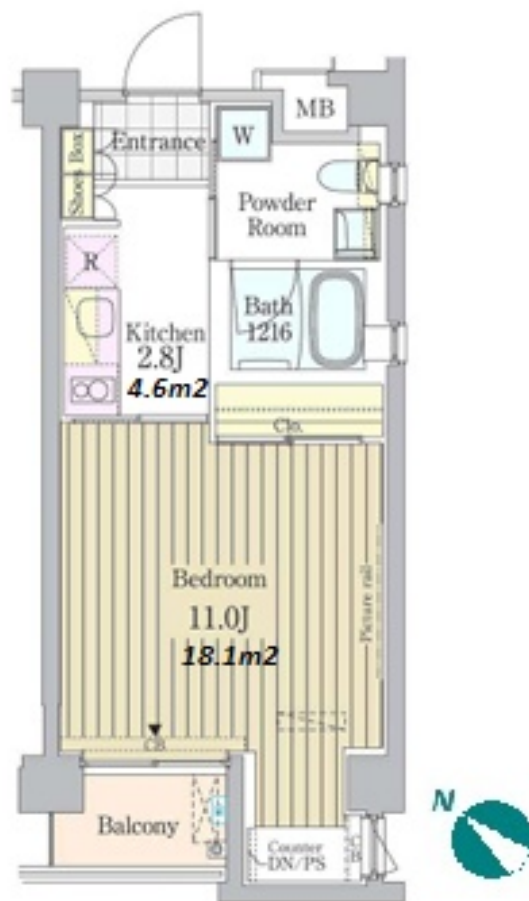

*The actual Layout & Size may differ slightly from this floor plans & pictures.

Lease Conditions			
LAYOUT	Studio		
SIZE	34.45 m ² /370.81 ft ²		
RENT	JPY 199,000 / month		
Management Fee	-		
Deposit	2 months	Key Money	-
Lease Term	Standard lease for 24 months		
Available	Now		
Renewal Fee	1 month		
Agent Fee	1 month + tax		
Other Info	Key Replacement Fee : JPY20,000 Tax not included / Guarantor Company : TBC / No Key Money / Auto lock / Air-Con / Separated Toilet / Balcony / Internet Included / Penalty Fee for Early Cancellation / CS/CATV / Flooring / Floor Heating / IH Stoves / Bathroom dryer		

Building Information			
Completion	Jan, 2014	Earthquake Resistance	New
Structure	RC, 5 story		
Car Parking	N/A		
Bicycle Parking	JPY500 + tax / month		
Music Instrument	-	Pet	-
Facilities	Trunk Room (JPY5,000 + tax / month) / Near Large Parks / Janitor / Delivery box / Elevator		

Remarks
Renters Insurance : Required



HOUSEREP TOKYO INC.

ハウスレップトーキョー株式会社

#301, 1-4-15, Hiroo, Shibuya-ku, Tokyo 150-0012, Japan

+81 (0)3 6427 5860

inquiry@housserep-tokyo.com

Transaction Type : Intermediate

Agent Fee : 1 month + tax

Website : www.housserep-tokyo.com

