

Property Name	PARK CUBE NISHIGAHARA STAGE	Unit No.	1208	TYPE	Apt.	Access	Nishisugamo Station on Mita Line (9 min) Nishigahara Station on Namboku Line (11 min) Sugamo Station on JR Yamanote Line (16 min)
Address	4-51-35, Nishigahara, Kita-Ku, Tokyo						

Residential Mid-rise Apt. in Nishigahara

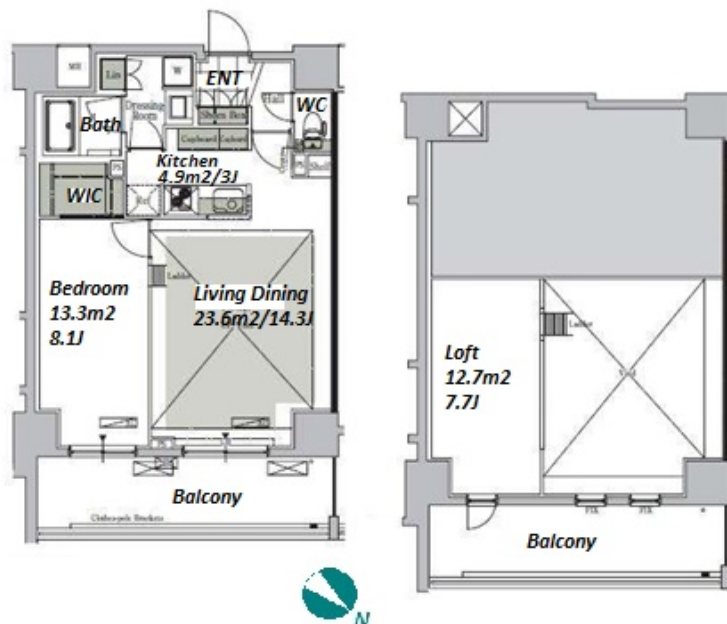
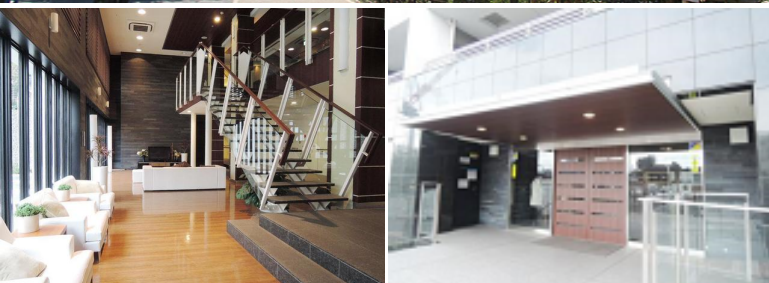

Lease Conditions			
LAYOUT	1 BR		
SIZE	56.11 m²/603.96 ft²		
RENT	JPY 192,000 / month		
Management Fee	JPY12,000/month		
Deposit	2 months	Key Money	1 month
Lease Term	Fixed term lease for 24 months		
Available	End, Feb, 2024		
Renewal Fee	-		
Agent Fee	1 month + tax		
Other Info	Key Replacement Fee : JPY15,000 Tax not included / Guarantor Company : TBC / Auto lock / Air-Con / Separated Toilet / Balcony / Loft/Maisonnette / Internet Included / Penalty Fee for Early Cancellation / Musical Instrument Negotiable / CS/CATV / Flooring / Floor Heating / Bathroom dryer / WIC		

Building Information			
Completion	Dec, 2009	Earthquake Resistance	New
Structure	RC, 14 story		
Car Parking	extra charge		
Bicycle Parking	for 2 spaces (Included)		
Musical Instrument	Negotiable	Pet	Allowed
Facilities	Motorcycle Parking (TBC) / Near Large Parks / Concierge / Delivery box / Elevator		

*The actual Layout & Size may differ slightly from this floor plans & pictures.



HOUSEREP TOKYO INC.

ハウスレップトーキョー株式会社

#301, 1-4-15, Hiroo, Shibuya-ku, Tokyo 150-0012, Japan

+81 (0)3 6427 5860

inquiry@housserep-tokyo.com

Transaction Type : Intermediate

Agent Fee : 1 month + tax

Website : www.housserep-tokyo.com



Remarks
Renters Insurance : Required / Town association fee: JPY.3,000/2years / Bicycle parking : Registration fee: JPY.2,000+tax / Pet:additional deposit (1 month) / Pet : a small dog or up to two cats