

Property Name	PARK CUBE NISHIGAHARA STAGE	Unit No.	817	TYPE	Apt.	Access	Nishisugamo Station on Mita Line (9 min) Nishigahara Station on Namboku Line (11 min) Sugamo Station on JR Yamanote Line (16 min)
Address	4-51-35, Nishigahara, Kita-Ku, Tokyo						

## Residential Mid-rise Apt. in Nishigahara

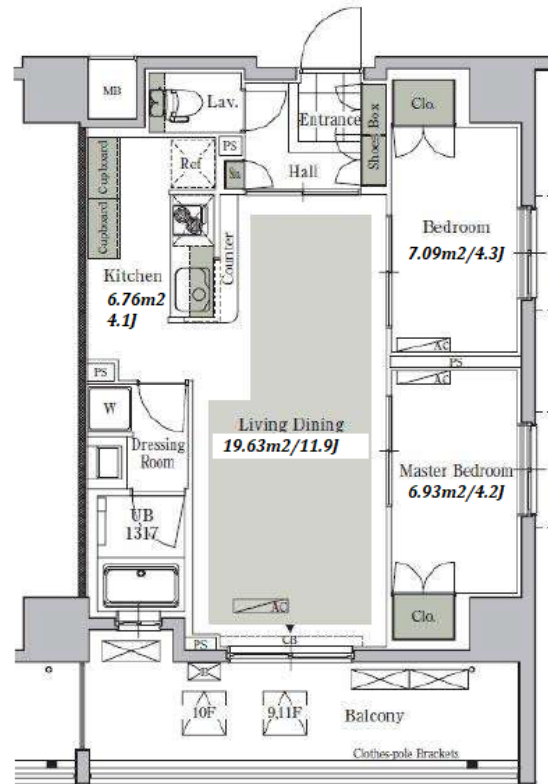

\*The actual Layout &amp; Size may differ slightly from this floor plans &amp; pictures.

Lease Conditions			
LAYOUT	2 BR		
SIZE	56.01 m²/602.88 ft²		
RENT	JPY 179,000 / month		
Management Fee	JPY12,000/month		
Deposit	2 months	Key Money	1 month
Lease Term	Fixed term lease for 24 months		
Available	End, Feb, 2024		
Renewal Fee	-		
Agent Fee	1 month + tax		
Other Info	Key Replacement Fee : JPY15,000 Tax not included / Guarantor Company : TBC / Auto lock / Air-Con / Separated Toilet / Balcony / Internet Included / Penalty Fee for Early Cancellation / Musical Instrument Negotiable / CS/CATV / Flooring / Floor Heating / Bathroom dryer		

Building Information			
Completion	Dec, 2009	Earthquake Resistance	New
Structure	RC, 14 story		
Car Parking	extra charge		
Bicycle Parking	for 2 spaces ( Included )		
Music Instrument	Negotiable	Pet	Allowed
Facilities	Motorcycle Parking (TBC) / Near Large Parks / Concierge / Delivery box / Elevator		

Remarks
Renters Insurance : Required / Town association fee: JPY.3,000/2yrs. / Bicycle parking : Registration fee: JPY.2,000+tax / Pet:additional deposit ( 1 month ) / Pet : a small dog or up to two cats



HOUSEREP TOKYO INC.  
ハウスレップトーキョー株式会社

#301, 1-4-15, Hiroo, Shibuya-ku, Tokyo 150-0012, Japan  
+81 (0)3 6427 5860 inquiry@housserrep-tokyo.com

Transaction Type : Intermediate  
Agent Fee : 1 month + tax

Website : www.housserrep-tokyo.com

