

Property Name	PARK SPHERE	Unit No.	TYPE	Access	Ushigomeyanagichou Station on Oedo Line (5 min) Kagurazaka Station on Tozai Line (10 min)
	USHIGOMEKAGURAZAKA	609	Apt.		
Address	3-3, Minamiyamabushicho, Shinjuku-Ku, Tokyo				

Modern Mid-rise Apt. in Kagurazaka

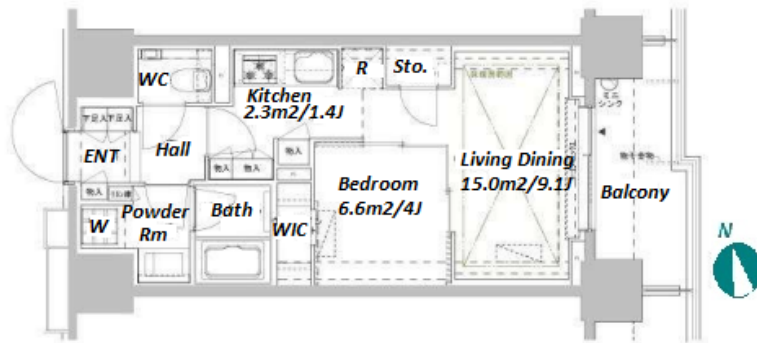

Lease Conditions			
LAYOUT	1 BR		
SIZE	40.01 m ² /430.66 ft ²		
RENT	JPY 205,000 / month		
Management Fee	JPY15,000/month		
Deposit	2 months	Key Money	1 month
Lease Term	Standard lease for 24 months		
Available	End, Mar, 2024		
Renewal Fee	1 month		
Agent Fee	1 month + tax		
Other Info	Key Replacement Fee : JPY15,000 Tax not included / Guarantor Company : TBC / Auto lock / Air-Con / Separated Toilet / Balcony / Penalty Fee for Early Cancellation / Musical Instrument Negotiable / CS/CATV / Flooring / Floor Heating / Dishwasher / Bathroom dryer / WIC		

Building Information			
Completion	Jul, 2021	Earthquake Resistance	New
Structure	RC, 13 story		
Car Parking	JPY45,000 + tax / month		
Bicycle Parking	N/A		
Music Instrument	Negotiable	Pet	Allowed
Facilities	Motorcycle Parking (TBC) / Janitor / Delivery box / Elevator / Close to Station / Newly-built (~7 y/o)		

*The actual Layout & Size may differ slightly from this floor plans & pictures.



HOUSEREP TOKYO INC.

ハウスレップトーキョー株式会社

#301, 1-4-15, Hiroo, Shibuya-ku, Tokyo 150-0012, Japan

+81 (0)3 6427 5860

inquiry@houserep-tokyo.com

Transaction Type : Intermediate

Agent Fee : 1 month + tax

Website : www.houserep-tokyo.com



Remarks
Renters Insurance : Required / Pet:additional deposit (1 month) / Pet : a small dog or a cat