

Property Name	BLAU SUMIYOSHI	Unit No.	TYPE	Access	Kikukawa Station on Toei Shinjuku Line (6 min) Sumiyoshi Station on Hanzomon Line (8 min)
		608	Apt.		
Address	5-2-9, Kotobashi, Sumida-Ku, Tokyo				

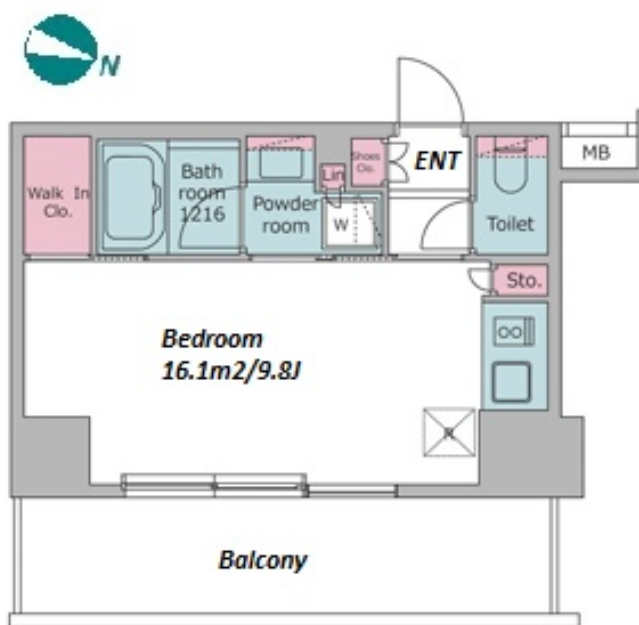
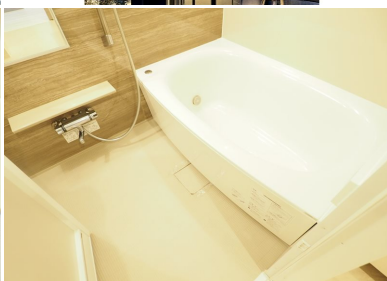

Lease Conditions			
LAYOUT	1 BR		
SIZE	25.21 m ² /271.35 ft ²		
RENT	JPY 101,000 / month		
Management Fee	JPY10,000/month		
Deposit	2 months	Key Money	1 month
Lease Term	Standard lease for 24 months		
Available	End, Feb, 2024		
Renewal Fee	1 month		
Agent Fee	1 month + tax		
Other Info	Key Replacement Fee : JPY35,000 Tax not included / Guarantor Company : TBC / Auto lock / Air-Con / Separated Toilet / Balcony / Flooring / Bathroom dryer / WIC		

Building Information			
Completion	Jan, 2019	Earthquake Resistance	New
Structure	RC, 7 story		
Car Parking	-		
Bicycle Parking	-		
Music Instrument	-	Pet	Allowed
Facilities	Delivery box / Elevator / Newly-built (~7 y/o)		

Remarks
Renters Insurance : Required / Pet:additional deposit (1 month) / Pet : a small dog or a cat

*The actual Layout & Size may differ slightly from this floor plans & pictures.



HOUSEREP TOKYO INC.

ハウスレップトーキョー株式会社

#301, 1-4-15, Hiroo, Shibuya-ku, Tokyo 150-0012, Japan

+81 (0)3 6427 5860

inquiry@housserep-tokyo.com

Transaction Type : Intermediate

Agent Fee : 1 month + tax

Website : www.housserep-tokyo.com

