

FOR RENT

Property ID No. :152031

HOUSEREP TOKYO INC.

Website : www.housserep-tokyo.com

Property Name	LEFOND PROGRES KIYOSUMISHIRAKAWA PREMIER	Unit No.	TYPE	Access	Kiyosumishirakawa Station on Hanzomon Line (4 min) Kikukawa Station on Toei Shinjuku Line (11 min)
		703	Apt.		
Address	2-23-7, Shirakawa, Koto-Ku, Tokyo				

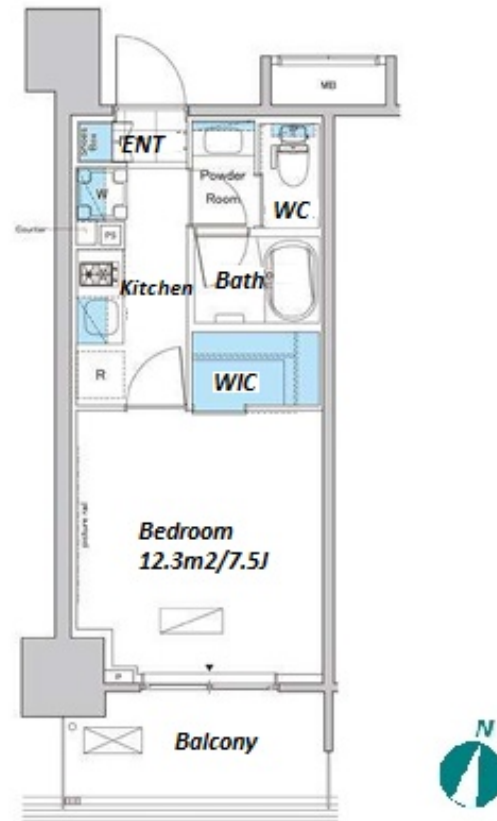

*The actual Layout & Size may differ slightly from this floor plans & pictures.

Lease Conditions			
LAYOUT	Studio		
SIZE	25.1 m²/270.17 ft²		
RENT	JPY 132,000 / month		
Management Fee	JPY10,000/month		
Deposit	2 months	Key Money	-
Lease Term	Standard lease for 24 months		
Available	End, Apr, 2024		
Renewal Fee	1 month		
Agent Fee	1 month + tax		
Other Info	Key Replacement Fee : JPY20,000 Tax not included / Guarantor Company : TBC / No Key Money / Auto lock / Air-Con / Separated Toilet / Balcony / Internet Included / Penalty Fee for Early Cancellation / CS/CATV / Flooring / Bathroom dryer / WIC		
Building Information			
Completion	Oct, 2019	Earthquake Resistance	New
Structure	RC, 11 story		
Car Parking	JPY35,000 + tax / month		
Bicycle Parking	for 1 space (Included)		
Music Instrument	-	Pet	Allowed
Facilities	Motorcycle Parking (JPY5,000 + tax / month) / Delivery box / Elevator / Security / Close to Station / Newly-built (~7 y/o)		

Remarks
Renters Insurance : Required / Parking : 1 month for deposit / Pet:additional deposit (1 month) / Pet : a small dog or a cat



HOUSEREP TOKYO INC.

ハウスレップトーキョー株式会社

#301, 1-4-15, Hiroo, Shibuya-ku, Tokyo 150-0012, Japan

+81 (0)3 6427 5860

inquiry@housserep-tokyo.com

Transaction Type : Intermediate

Agent Fee : 1 month + tax

Website : www.housserep-tokyo.com

