

Property Name	PARK AXIS HIGASHI KAMATA	Unit No.	TYPE	Access	Umeyashiki Station on Keikyu Line (5 min) Keikyuukamata Station on Keikyu Line (8 min)
		715	Apt.		
Address	1-10-8, Higashikamata, Ota-Ku, Tokyo				

Mid rise apartment in TOKYO near Kamata Sta.

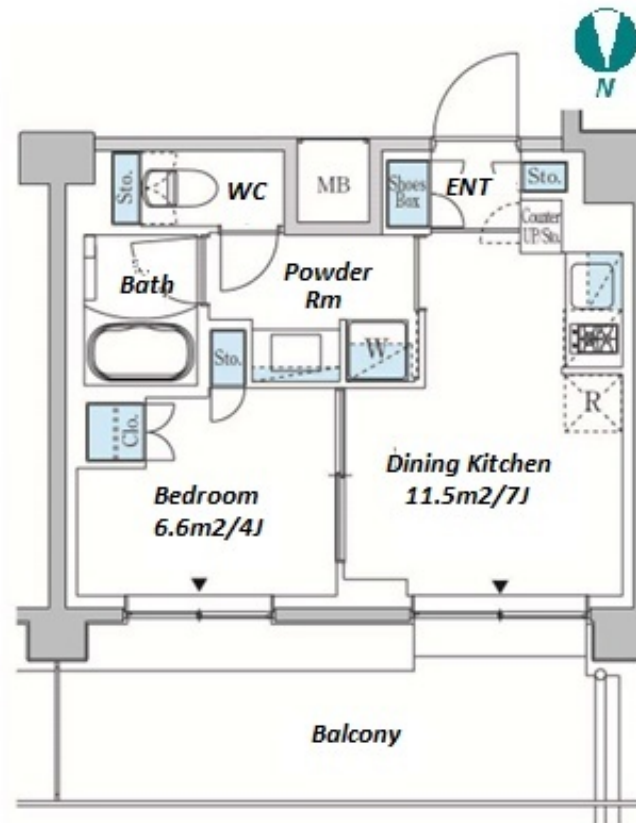

*The actual Layout & Size may differ slightly from this floor plans & pictures.

Lease Conditions			
LAYOUT	1 BR		
SIZE	30.19 m²/324.96 ft²		
RENT	JPY 125,000 / month		
Management Fee	JPY10,000/month		
Deposit	2 months	Key Money	1 month
Lease Term	Standard lease for 24 months		
Available	Now		
Renewal Fee	1 month		
Agent Fee	1 month + tax		
Other Info	Key Replacement Fee : JPY20,000 Tax not included / Guarantor Company : TBC / Auto lock / Air-Con / Separated Toilet / Balcony / Penalty Fee for Early Cancellation / CS/CATV / Flooring / Bathroom dryer		

Building Information			
Completion	Feb, 2021	Earthquake Resistance	New
Structure	RC, 8 story		
Car Parking	-		
Bicycle Parking	for 1 space (Included)		
Music Instrument	-	Pet	-
Facilities	Motorcycle Parking (JPY3,000 + tax / month) / Janitor / Delivery box / Elevator / Security / Close to Station / Newly-built (~7 y/o)		

Remarks
Renters Insurance : Required / Bicycle parking : Initial One-time fee of 2,000yen+Tax for parking sticker



HOUSEREP TOKYO INC.

ハウスレップトーキョー株式会社

#301, 1-4-15, Hiroo, Shibuya-ku, Tokyo 150-0012, Japan

+81 (0)3 6427 5860 inquiry@housserep-tokyo.com

Transaction Type : Intermediate

Agent Fee : 1 month + tax

Website : www.housserep-tokyo.com

