

FOR RENT

Property ID No. :151882

HOUSEREP TOKYO INC.

Website : www.houserep-tokyo.com

Property Name	RESIDIA NIHOMBASHI BAKUROCHO	Unit No.	TYPE	Access	Bakurochou Station on JR Sobu Line (1 min) Kodenmachou Station on Hibiya Line (7 min) Akihabara Station on JR Yamanote Line (13 min)
		1103	Apt.		
Address	1-4-14, Nihombashibakurocho, Chuo-Ku, Tokyo				

Stylish apartment in Nihombashi Bakurocho area.

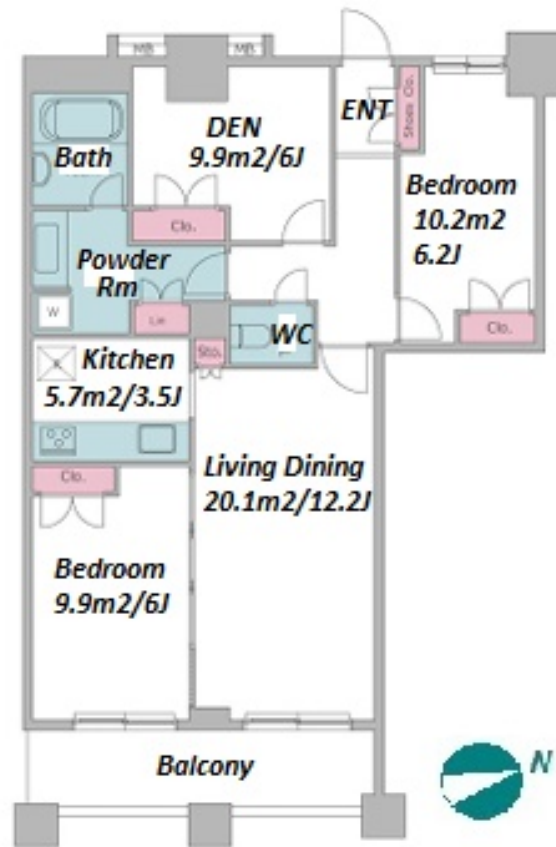

Lease Conditions			
LAYOUT	2 BR+Den		
SIZE	77.43 m²/833.44 ft²		
RENT	JPY 395,000 / month		
Management Fee	JPY15,000/month		
Deposit	2 months	Key Money	1 month
Lease Term	Standard lease for 24 months		
Available	Now		
Renewal Fee	1 month		
Agent Fee	1 month + tax		
Other Info	Key Replacement Fee : JPY18,000 Tax not included / Guarantor Company : TBC / Auto lock / Renovated / Air-Con / Separated Toilet / Balcony / Internet (Extra Charge) / Penalty Fee for Early Cancellation / Flooring / Bathroom dryer		

Building Information			
Completion	Feb, 2007	Earthquake Resistance	New
Structure	RC, 17 story		
Car Parking	TBC		
Bicycle Parking	TBC		
Music Instrument	-	Pet	Allowed
Facilities	Delivery box / Elevator		

\*The actual Layout & Size may differ slightly from this floor plans & pictures.



HOUSEREP TOKYO INC.

ハウズレップトーキョー株式会社

#301, 1-4-15, Hiroo, Shibuya-ku, Tokyo 150-0012, Japan

+81 (0)3 6427 5860 inquiry@houserep-tokyo.com

Transaction Type : Intermediate

Agent Fee : 1 month + tax

Website : www.houserep-tokyo.com



Remarks
<p>Renters Insurance : Required / Tenant support fee: JPY.10,000+tax/2years Internet fee: JPY.1,500+tax/month / Pet:additional deposit ( 1 month ) / Pet : a small dog or a cat</p>