

Property Name	WISTERIA COURT DAIKANYAMA	Unit No.	TYPE	Access	Daikannyama Station on Toyoko Line (5 min) Ebisu Station on Hibiya Line (9 min) Shibuya Station on JR Yamanote Line (10 min)
		6	Apt.		
Address	10-12, Daikanyamacho, Shibuya-Ku, Tokyo				

Mid rise apartment in Shibuya area near Daikanyama Sta.

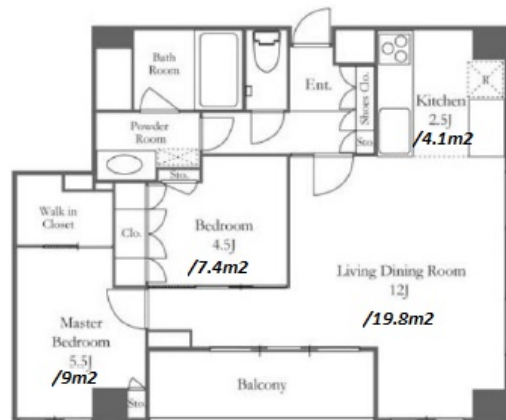

Lease Conditions			
LAYOUT	2 BR		
SIZE	64.49 m ² /694.16 ft ²		
RENT	JPY 367,000 / month		
Management Fee	JPY8,000/month		
Deposit	2 months	Key Money	1 month
Lease Term	Fixed term lease for 36 months		
Available	Now		
Renewal Fee	-		
Agent Fee	1 month + tax		
Other Info	Auto lock / Air-Con / Separated Toilet / Balcony / Musical Instrument Negotiable / Floor Heating / Washer / Dryer / Dishwasher / Bathroom dryer / WIC / Corner Unit		

Building Information			
Completion	Feb, 1998	Earthquake Resistance	New
Structure	SRC, 9 story		
Car Parking	JPY45,000 + tax / month		
Bicycle Parking	TBC		
Music Instrument	Negotiable	Pet	N/A
Facilities	Motorcycle Parking (TBC) / Janitor / Delivery box / Elevator / Close to Station		

Remarks
Renters Insurance : Required

*The actual Layout & Size may differ slightly from this floor plans & pictures.



HOUSEREP TOKYO INC.

ハウスレップトーキョー株式会社

#301, 1-4-15, Hiroo, Shibuya-ku, Tokyo 150-0012, Japan

+81 (0)3 6427 5860

inquiry@housserep-tokyo.com

Transaction Type : Intermediate

Agent Fee : 1 month + tax

Website : www.housserep-tokyo.com

