

Property Name	CLAIR NIHONBASHI	Unit No.	TYPE	Access	Bakurochou Station on JR Sobu Line (2 min) Bakuroyokoyama Station on Toei Shinjuku Line (3 min)
		602	Apt.		
Address	1-8-1, Nihombashibakurocho, Chuo-Ku, Tokyo				

All corner units. Modern Apt. with full of light in Nihonbashi

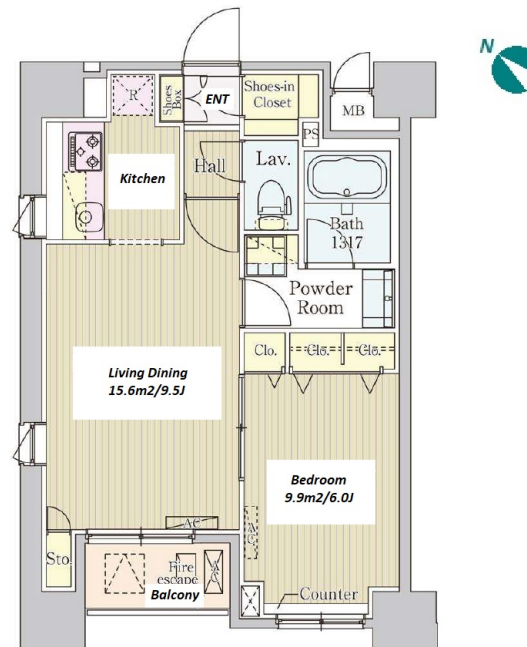

Lease Conditions			
LAYOUT	1 BR		
SIZE	45.06 m²/485.02 ft²		
RENT	JPY 184,000 / month		
Management Fee	JPY15,000/month		
Deposit	1 month	Key Money	1 month
Lease Term	Standard lease for 24 months		
Available	Negotiable		
Renewal Fee	1 month		
Agent Fee	1 month + tax		
Other Info	Key Replacement Fee : JPY20,000 Tax not included / Guarantor Company : TBC / Auto lock / Air-Con / Separated Toilet / Balcony / Penalty Fee for Early Cancellation / CS/CATV / Flooring / Bathroom dryer / Corner Unit		

Building Information			
Completion	Jan, 2017	Earthquake Resistance	New
Structure	RC, 14 story		
Car Parking	N/A		
Bicycle Parking	for 1 space ( Included )		
Music Instrument	-	Pet	-
Facilities	Within 20 min to Tokyo station by car / Janitor / Delivery box		

Remarks
Renters Insurance : Required

\*The actual Layout & Size may differ slightly from this floor plans & pictures.



HOUSEREP TOKYO INC.

ハウスレップトーキョー株式会社

#301, 1-4-15, Hiroo, Shibuya-ku, Tokyo 150-0012, Japan

+81 (0)3 6427 5860

inquiry@housserep-tokyo.com

Transaction Type : Intermediate

Agent Fee : 1 month + tax

Website : www.housserep-tokyo.com

