

Property Name	IPSE KAMATA	Unit No.	TYPE	Access	Kamata Station on JR Keihin Tohoku Line (3 min) Kamata Station on Tokyu Ikegami Line (3 min)
		1402	Apt.		
Address	7-45-1, Nishikamata, Ota-Ku, Tokyo				

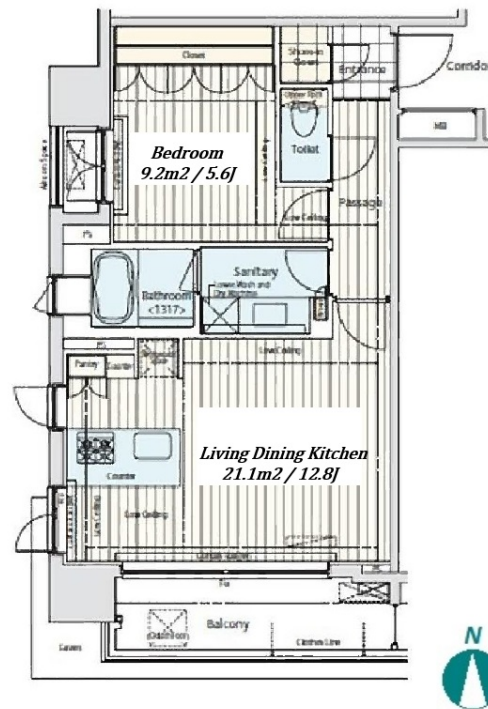

Lease Conditions			
LAYOUT	1 BR		
SIZE	46.99 m²/505.79 ft²		
RENT	JPY 190,000 / month		
Management Fee	JPY15,000/month		
Deposit	1 month	Key Money	-
Lease Term	Standard lease for 24 months		
Available	Now		
Renewal Fee	1 month		
Agent Fee	1 month + tax		
Other Info	Key Replacement Fee : JPY25,000 Tax not included / No Key Money / Free rent / Auto lock / Air-Con / Separated Toilet / Balcony / Flooring / Bathroom dryer / Corner Unit		

Building Information			
Completion	Mar, 2007	Earthquake Resistance	New
Structure	RC, 14 story		
Car Parking	JPY28,000/ month		
Bicycle Parking	(Included)		
Music Instrument	-	Pet	-
Facilities	Near Large Parks / Elevator		

*The actual Layout & Size may differ slightly from this floor plans & pictures.



HOUSEREP TOKYO INC.

ハウスレップトーキョー株式会社

#301, 1-4-15, Hiroo, Shibuya-ku, Tokyo 150-0012, Japan

+81 (0)3 6427 5860

inquiry@houserep-tokyo.com

Transaction Type : Intermediate

Agent Fee : 1 month + tax

Website : www.houserep-tokyo.com



Remarks
Renters Insurance : Required