

Property Name	PARK AXIS HATAGAYA	Unit No.	TYPE	Access	Hatagaya Station on Keio Line (2 min)
Address		1101	Apt.		

Designer's Apartment in Hatagaya, near "Yoyogi Park" & Shinjuku Sta.

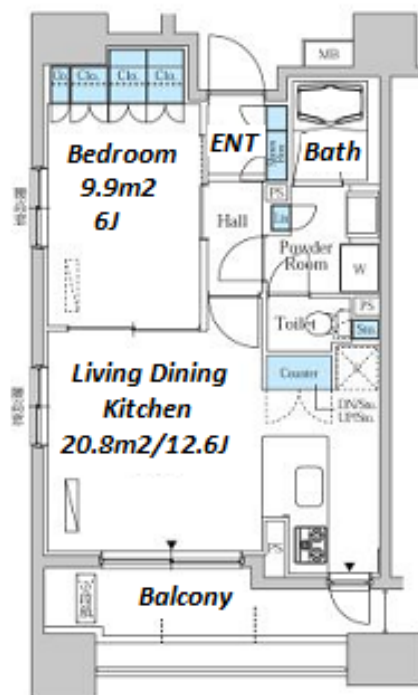

Lease Conditions	
LAYOUT	1 BR
SIZE	45.6 m <sup>2</sup> /490.83 ft <sup>2</sup>
RENT	JPY 229,000 / month
Management Fee	JPY10,000/month
Deposit	2 months
Key Money	-
Lease Term	Standard lease for 24 months
Available	Now
Renewal Fee	1 month
Agent Fee	1 month + tax
Other Info	Key Replacement Fee : JPY20,000 Tax not included / Guarantor Company : TBC / Auto lock / Air-Con / Separated Toilet / Balcony / Musical Instrument Negotiable / CS/CATV / Flooring / Bathroom dryer

Building Information			
Completion	Apr, 2008	Earthquake Resistance	New
Structure	RC, 14 story		
Car Parking	N/A		
Bicycle Parking	for 1 space ( Included )		
Music Instrument	Negotiable	Pet	Allowed
Facilities	Motorcycle Parking (TBC) / Delivery box / Close to Station		

\*The actual Layout & Size may differ slightly from this floor plans & pictures.



HOUSEREP TOKYO INC.

ハウスレップトーキョー株式会社

#301, 1-4-15, Hiroo, Shibuya-ku, Tokyo 150-0012, Japan

+81 (0)3 6427 5860

inquiry@housserep-tokyo.com

Transaction Type : Intermediate

Agent Fee : 1 month + tax

Website : www.housserep-tokyo.com



Remarks
Renters Insurance : Required / Pet:additional deposit ( 1 month ) / Pet : up to two small dogs or two cats