

Property Name	THE PARK HABIO KAMATA	Unit No.	TYPE	Access	Kamata Station on JR Keihin Tohoku Line (4 min) Kamata Station on Tokyu Ikegami Line (6 min) Keikyuukamata Station on Keikyu Line (8 min)
		901	Apt.		
Address	5-8-3, Kamata, Ota-Ku, Tokyo				

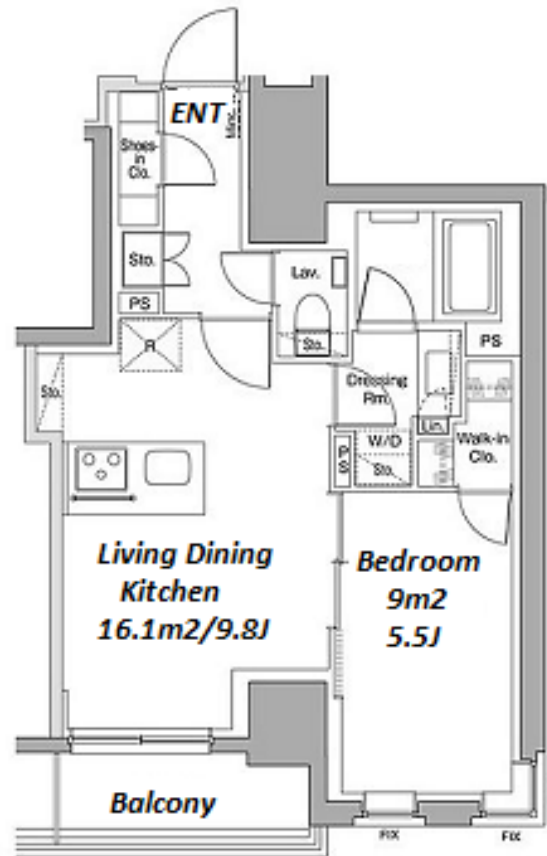

## Lease Conditions

LAYOUT	1 BR		
SIZE	40.38 m²/434.64 ft²		
RENT	JPY 179,000 / month		
Management Fee	JPY15,000/month		
Deposit	2 months	Key Money	-
Lease Term	Standard lease for 24 months		
Available	End, Apr, 2024		
Renewal Fee	1 month		
Agent Fee	1 month + tax		
Other Info	Key Replacement Fee : JPY20,000 Tax not included / Guarantor Company : TBC / No Key Money / Free rent / Auto lock / Air-Con / Separated Toilet / Balcony / Internet Included / Penalty Fee for Early Cancellation / Musical Instrument Negotiable / Flooring / Bathroom dryer / WIC		

## Building Information

Completion	Feb, 2020	Earthquake Resistance	New
Structure	RC, 11 story		
Car Parking	JPY35,000 + tax / month		
Bicycle Parking	JPY300 + tax / month		
Music Instrument	Negotiable	Pet	Allowed
Facilities	Motorcycle Parking (JPY5,000 + tax / month) / Delivery box / Elevator		

## Remarks

Renters Insurance : Required / Pet:additional deposit ( 1 month ) / Pet :  
a small dog or up to two cats

\*The actual Layout & Size may differ slightly from this floor plans & pictures.



# HOUSEREP TOKYO INC.

ハウスレップトーキョー株式会社

#301, 1-4-15, Hiroo, Shibuya-ku, Tokyo 150-0012, Japan

+81 (0)3 6427 5860

inquiry@housserep-tokyo.com

Transaction Type : Intermediate

Agent Fee : 1 month + tax

Website : www.housserep-tokyo.com

