

FOR RENT

Property ID No. :143456

HOUSEREP TOKYO INC.

Website : www.housserep-tokyo.com

Property Name	PARK AXIS IRIYA	Unit No.	TYPE	Access	Iriya Station on Hibiya Line (5 min)
		1406	Apt.		
Address	2-38-4, Iriya, Taito-Ku, Tokyo				

Mid-rise Apt. in Iriya, near ueno

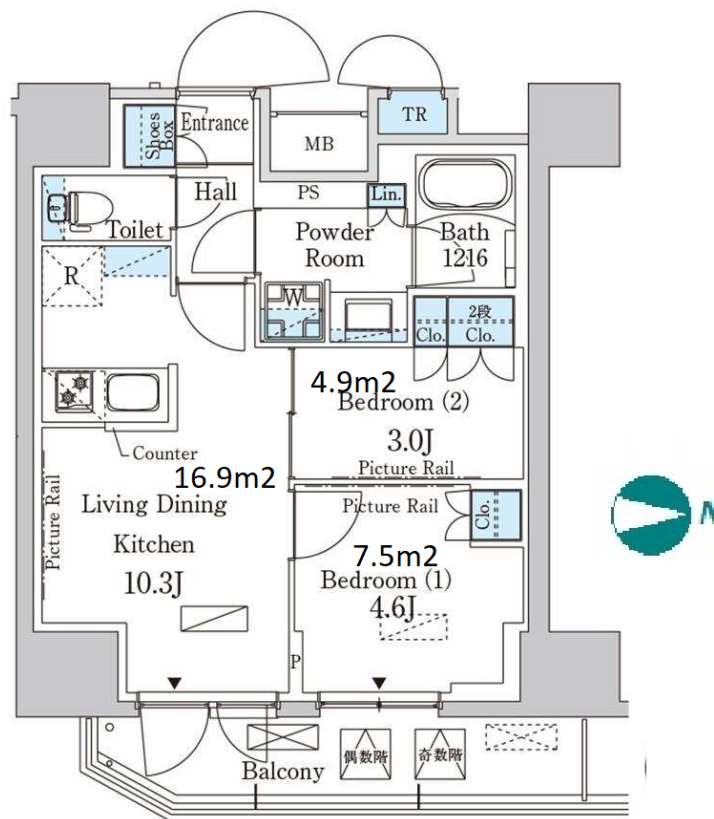

*The actual Layout & Size may differ slightly from this floor plans & pictures.

Lease Conditions		
LAYOUT	2 BR	
SIZE	43.36 m²/466.72 ft²	
RENT	JPY 192,000 / month	
Management Fee	JPY20,000/month	
Deposit	2 months	Key Money -
Lease Term	Standard lease for 24 months	
Available	Early, Feb, 2024	
Renewal Fee	1 month	
Agent Fee	1 month + tax	
Other Info	Key Replacement Fee : JPY25,000 Tax included / Guarantor Company : TBC / No Key Money / Auto lock / Air-Con / Separated Toilet / Balcony / Penalty Fee for Early Cancellation / Musical Instrument Negotiable / CS/CATV / Flooring / Bathroom dryer	

Building Information			
Completion	Mar, 2022	Earthquake Resistance	New
Structure	RC, 14 story		
Car Parking	JPY35,000/ month		
Bicycle Parking	for 1 space (Included)		
Music Instrument	Negotiable	Pet	Allowed
Facilities	Motorcycle Parking (TBC) / Janitor / Delivery box / Elevator / Close to Station / Newly-built (~1 y/o)		

Remarks
Renters Insurance : Required / Bicycle parking : Regisration fee: JPY.2,000+tax / Pet:additional deposit (1 month) / Pet : a small dog or a cat



HOUSEREP TOKYO INC.

ハウスレップトーキョー株式会社

#301, 1-4-15, Hiroo, Shibuya-ku, Tokyo 150-0012, Japan

+81 (0)3 6427 5860 inquiry@housserep-tokyo.com

Transaction Type : Intermediate

Agent Fee : 1 month + tax

Website : www.housserep-tokyo.com

