

FOR RENT

Property ID No. :143333

HOUSEREP TOKYO INC.

Website : www.houserep-tokyo.com

Property Name	KDX RESIDENCE NIHOMBASHIHAKOZAKI	Unit No.	TYPE	Access	Suitennguumae Station on Hanzomon Line (3 min) Ninngyouchou Station on Hibiya Line (9 min)
		1201	Apt.		
Address	38-1, Nihombashihakozakicho, Chuo-Ku, Tokyo				

Middle Rise Apt. in Hakozakicho, Near Sumida-river

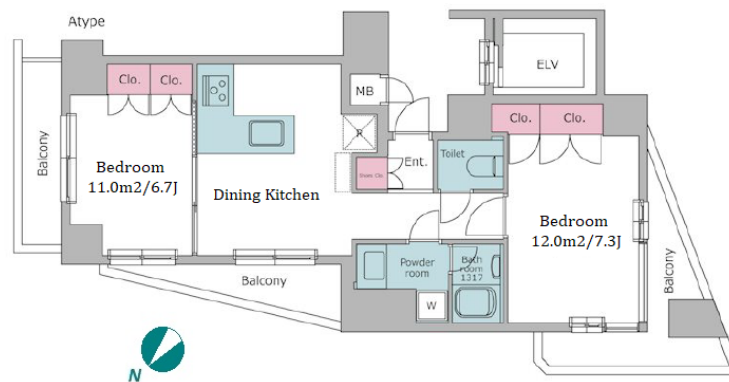

Lease Conditions			
LAYOUT	2 BR		
SIZE	51.28 m ² /551.97 ft ²		
RENT	JPY 234,000 / month		
Management Fee	JPY15,000/month		
Deposit	2 months	Key Money	1 month
Lease Term	Standard lease for 24 months		
Available	Early, Apr, 2024		
Renewal Fee	1 month		
Agent Fee	1 month + tax		
Other Info	Key Replacement Fee : JPY27,000 Tax not included / Guarantor Company : TBC / Auto lock / Air-Con / Separated Toilet / Balcony / Penalty Fee for Early Cancellation / Flooring / Bathroom dryer		

Building Information			
Completion	Mar, 2004	Earthquake Resistance	New
Structure	SRC, 112 story		
Car Parking	N/A		
Bicycle Parking	TBC		
Music Instrument	-	Pet	N/A
Facilities	Delivery box / Elevator		

Remarks
Renters Insurance : Required

*The actual Layout & Size may differ slightly from this floor plans & pictures.



HOUSEREP TOKYO INC.

ハウスレップトーキョー株式会社

#301, 1-4-15, Hiroo, Shibuya-ku, Tokyo 150-0012, Japan

+81 (0)3 6427 5860 inquiry@houserep-tokyo.com

Transaction Type : Intermediate

Agent Fee : 1 month + tax

Website : www.houserep-tokyo.com

