

Property Name	GRAN PASEO YOKOHAMA KANNAI PREMIUM	Unit No.	TYPE	Access	Kannnai Station on JR Negishi Line (5 min) Kannnai Station on JR Keihin Tohoku Line (5 min) Ishikawachou Station on JR Negishi Line (10 min)
		1103	Apt.		
Address	2-7-12, Okinacho, Naka-Ku, Yokohama-Shi, Kanagawa				

Stylish Mid Rise Apt. in Kannnai, near Yokohama Stadium

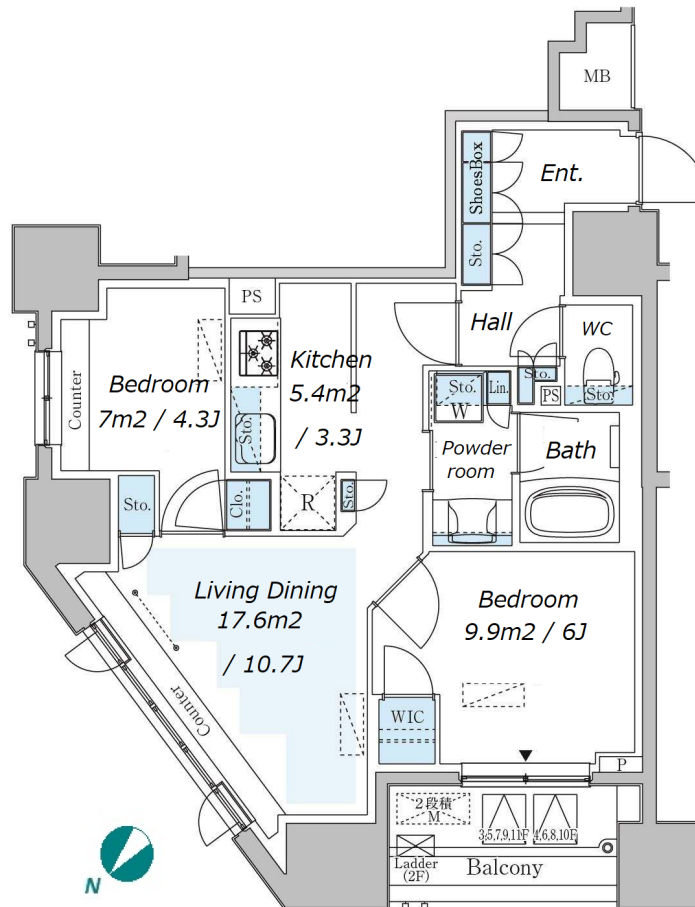
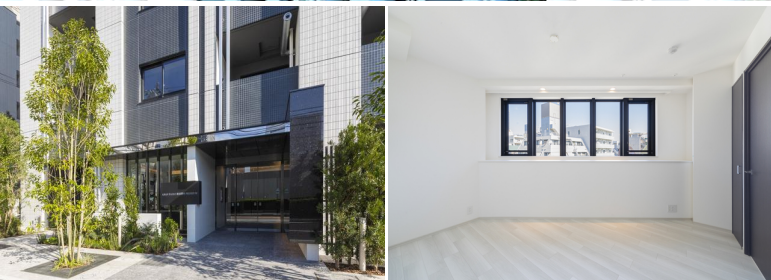

Lease Conditions			
LAYOUT	2 BR		
SIZE	56.83 m²/611.71 ft²		
RENT	JPY 191,000 / month		
Management Fee	JPY15,000/month		
Deposit	2 months	Key Money	-
Lease Term	Standard lease for 24 months		
Available	Mid, May, 2024		
Renewal Fee	1 month		
Agent Fee	1 month + tax		
Other Info	Key Replacement Fee : JPY20,000 Tax not included / Guarantor Company : TBC / No Key Money / Auto lock / Air-Con / Separated Toilet / Balcony / Internet (Extra Charge) / Penalty Fee for Early Cancellation / CS/CATV / Flooring / Floor Heating / Dishwasher / Bathroom dryer / WIC		

Building Information			
Completion	Sep, 2021	Earthquake Resistance	New
Structure	RC, 11 story		
Car Parking	JPY30,000 + tax / month		
Bicycle Parking	extra charge		
Music Instrument	-	Pet	N/A
Facilities	Near Large Parks / Janitor / Delivery box / Elevator		

*The actual Layout & Size may differ slightly from this floor plans & pictures.



HOUSEREP TOKYO INC.

ハウスレップトーキョー株式会社

#301, 1-4-15, Hiroo, Shibuya-ku, Tokyo 150-0012, Japan

+81 (0)3 6427 5860

inquiry@housserrep-tokyo.com

Transaction Type : Intermediate

Agent Fee : 1 month + tax

Website : www.housserrep-tokyo.com



Remarks
Renters Insurance : Required