

FOR RENT

Property ID No. :139482

HOUSEREP TOKYO INC.

Website : www.housserrep-tokyo.com

Property Name	RIVER CITY 21 EAST TOWERS 10	Unit No.	TYPE	Access	Tsukishima Station on Oedo Line (5 min) Tsukishima Station on Yurakucho Line (7 min) Hacchoubori Station on Hibiya Line (13 min)
		1211	Apt.		
Address	2-2-10, Tsukuda, Chuo-Ku, Tokyo				

## Renovated Waterfront Apt. in Tsukishima, Tokyo Bay Area

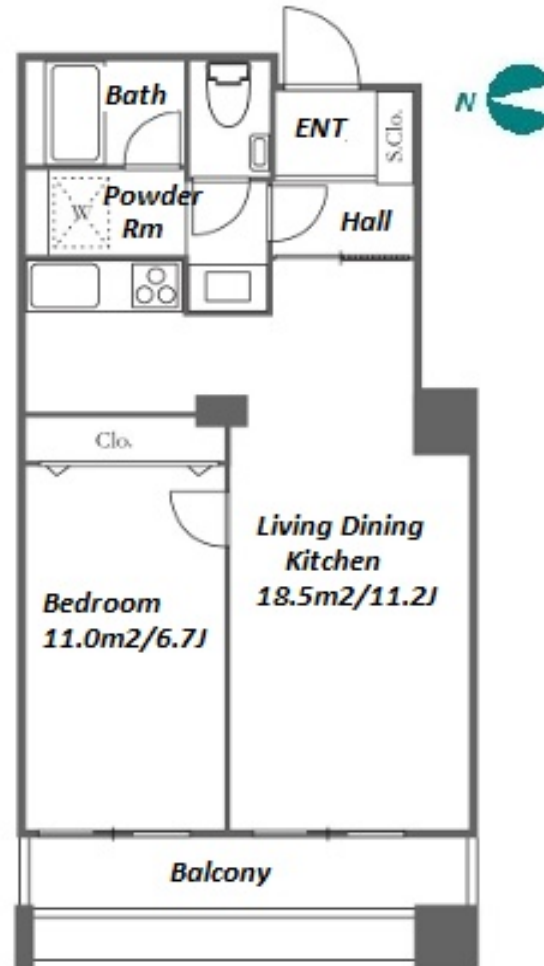

\*The actual Layout & Size may differ slightly from this floor plans & pictures.

Lease Conditions			
LAYOUT	1 BR		
SIZE	47.23 m <sup>2</sup> /508.37 ft <sup>2</sup>		
RENT	JPY 194,000 / month		
Management Fee	JPY10,000/month		
Deposit	2 months	Key Money	-
Lease Term	Standard lease for 24 months		
Available	Mid, Apr, 2024		
Renewal Fee	1 month		
Agent Fee	1 month + tax		
Other Info	Key Replacement Fee : JPY15,000 Tax not included / Guarantor Company : TBC / No Key Money / Auto lock / Air-Con / Separated Toilet / Balcony / Penalty Fee for Early Cancellation / Nice Views / Flooring / IH Stoves / Bathroom dryer		

Building Information			
Completion	Mar, 1991	Earthquake Resistance	New
Structure	SRC, 37 story		
Car Parking	JPY30,000 + tax / month		
Bicycle Parking	TBC		
Music Instrument	-	Pet	N/A
Facilities	Motorcycle Parking (TBC) / Trunk Room ((Included)) / Within 20 min to Tokyo station by car / Near Large Parks / Janitor / Delivery box / Elevator / High-rise		

Remarks
Renters Insurance : Required / Parking : 3 months deposit



# HOUSEREP TOKYO INC.

ハウスレップトーキョー株式会社

#301, 1-4-15, Hiroo, Shibuya-ku, Tokyo 150-0012, Japan

+81 (0)3 6427 5860

inquiry@housserrep-tokyo.com

Transaction Type : Intermediate

Agent Fee : 1 month + tax

Website : www.housserrep-tokyo.com

