

| | | | | | |
|---------------|--------------------------------------|----------|------|--------|---|
| Property Name | GARDEN HARAJUKU | Unit No. | TYPE | Access | Meijijinnguumae harajuku Station on Chiyoda Line (6 min) Harajuku Station on JR Yamanote Line (10 min) |
| | | 201 | Apt. | | |
| Address | 4-18-15, Jingumae, Shibuya-Ku, Tokyo | | | | |

Stylish Low Rise Apt. in Harajuku / Omotesando

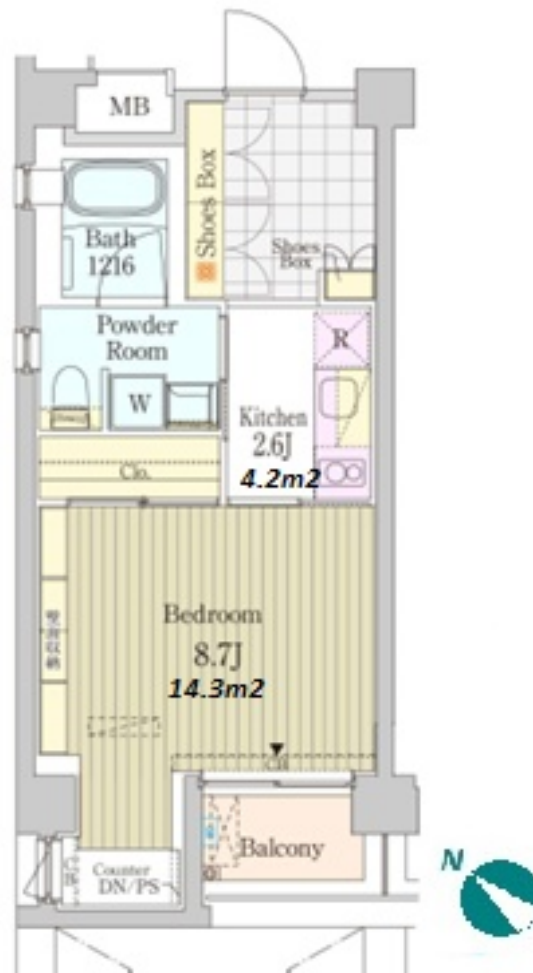

*The actual Layout & Size may differ slightly from this floor plans & pictures.

| Lease Conditions | | | |
|------------------|---|-----------|---------|
| LAYOUT | Studio | | |
| SIZE | 34.28 m²/368.98 ft² | | |
| RENT | JPY 189,000 / month | | |
| Management Fee | - | | |
| Deposit | 2 months | Key Money | 1 month |
| Lease Term | Standard lease for 24 months | | |
| Available | End, Feb, 2024 | | |
| Renewal Fee | 1 month | | |
| Agent Fee | 1 month + tax | | |
| Other Info | Key Replacement Fee : JPY20,000 Tax not included / Guarantor Company : TBC / Auto lock / Air-Con / Separated Toilet / Balcony / Internet Included / CS/CATV / Flooring / Floor Heating / IH Stoves / Bathroom dryer | | |

| Building Information | | | |
|----------------------|--|-----------------------|-----|
| Completion | Jan, 2014 | Earthquake Resistance | New |
| Structure | RC, 5 story | | |
| Car Parking | N/A | | |
| Bicycle Parking | JPY500 + tax / month | | |
| Music Instrument | - | Pet | - |
| Facilities | Trunk Room (JPY5,000 + tax / month) / Near Large Parks / Janitor / Delivery box / Elevator | | |

| Remarks |
|------------------------------|
| Renters Insurance : Required |



HOUSEREP TOKYO INC.

ハウスレップトーキョー株式会社

#301, 1-4-15, Hiroo, Shibuya-ku, Tokyo 150-0012, Japan

+81 (0)3 6427 5860

inquiry@housserep-tokyo.com

Transaction Type : Intermediate

Agent Fee : 1 month + tax

Website : www.housserep-tokyo.com

