

Property Name	IIDABASHI GARDEN FLATS	Unit No.	TYPE	Access	Iidabashi Station on Namboku Line (7 min) Iidabashi Station on JR Chuo Line Rapid Service (8 min) Iidabashi Station on Tozai Line (8 min)
		617	Apt.		
Address	4-11, Shinogawamachi, Shinjuku-Ku, Tokyo				

## New Luxury Apt. in Iidabashi, near "Kagurazaka Shopping Streets"

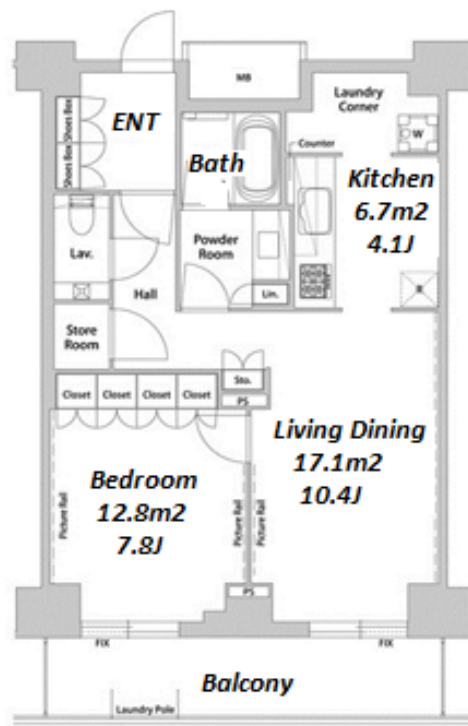
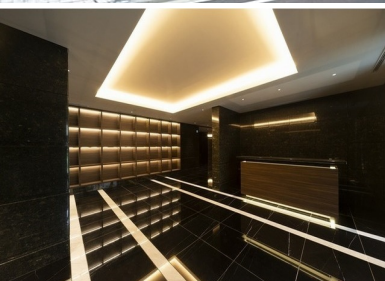

Lease Conditions			
LAYOUT	1 BR		
SIZE	62.65 m²/674.35 ft²		
RENT	JPY 282,000 / month		
Management Fee	JPY20,000/month		
Deposit	2 months	Key Money	2 months
Lease Term	Fixed term lease for 24 months		
Available	End, Mar, 2024		
Renewal Fee	-		
Agent Fee	1 month + tax		
Other Info	Key Replacement Fee : JPY25,000 Tax not included / Guarantor Company : TBC / Auto lock / Air-Con / Separated Toilet / Balcony / Internet (Extra Charge) / CS/CATV / Dishwasher / Bathroom dryer		

Building Information			
Completion	Jul, 2018	Earthquake Resistance	New
Structure	RC, 8 story		
Car Parking	extra charge		
Bicycle Parking	JPY500 + tax / month		
Music Instrument	-	Pet	N/A
Facilities	Within 20 min to Roppongi by train / Within 20 min to Tokyo station by car / Near Large Parks / Delivery box / Elevator		

Remarks
Fixed term lease : Re-Contract fee : 1 month of new rent

\*The actual Layout & Size may differ slightly from this floor plans & pictures.



**HOUSEREP TOKYO INC.**

ハウズレップトーキョー株式会社

#301, 1-4-15, Hiroo, Shibuya-ku, Tokyo 150-0012, Japan

+81 (0)3 6427 5860 inquiry@housserep-tokyo.com

Transaction Type : Intermediate

Agent Fee : 1 month + tax

Website : www.housserep-tokyo.com

