

Property Name	PARK AXIS GAKUGEIDAIGAKU RESIDENCE	Unit No.	TYPE	Access	Gakugeidaigaku Station on Toyoko Line (11 min) Toritsudaigaku Station on Toyoko Line (15 min)
		410	Apt.		
Address	2-1-20, Kakinokizaka, Meguro-Ku, Tokyo				

Stylish Mid-rise Apt. near Komazawa Olympic Park

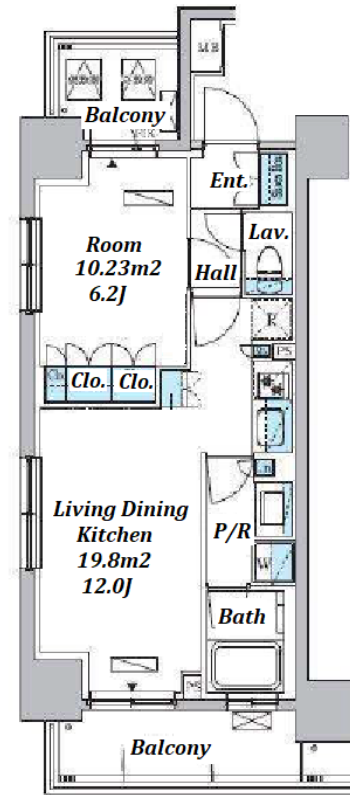

Lease Conditions			
LAYOUT	1 BR		
SIZE	43.01 m²/462.95 ft²		
RENT	JPY 208,000 / month		
Management Fee	-		
Deposit	2 months	Key Money	1 month
Lease Term	Standard lease for 24 months		
Available	Mid, Apr, 2024		
Renewal Fee	1 month		
Agent Fee	1 month + tax		
Other Info	Key Replacement Fee : JPY20,000 Tax not included / Guarantor Company : TBC / Auto lock / Air-Con / Separated Toilet / Balcony / Internet (Extra Charge) / Musical Instrument Negotiable / CS/CATV / Flooring / Bathroom dryer		

Building Information			
Completion	Feb, 2019	Earthquake Resistance	New
Structure	RC, 9 story		
Car Parking	extra charge		
Bicycle Parking	for 1 space (Included)		
Music Instrument	Negotiable	Pet	Allowed
Facilities	Motorcycle Parking (TBC) / Near Large Parks / Janitor / Delivery box / Elevator / Newly-built (~7 y/o)		

Remarks
Renters Insurance : Required / Pet:additional deposit (1 month)

*The actual Layout & Size may differ slightly from this floor plans & pictures.



HOUSEREP TOKYO INC.

ハウスレップトーキョー株式会社

#301, 1-4-15, Hiroo, Shibuya-ku, Tokyo 150-0012, Japan

+81 (0)3 6427 5860 inquiry@houserep-tokyo.com

Transaction Type : Intermediate

Agent Fee : 1 month + tax

Website : www.houserep-tokyo.com

